



# Moravia

YACHTING

## B2

Builder	Abeking & Rasmussen
Year/Refit	2009/2022
LOA	85.6m (280' 8")
Beam	12.4m (40' 7")
Draft	3.45m (11' 3")
GT	2150
Cabins	11
Guests	22
Speed	15/16.5
Price	€79,000,000



A Hill Robinson Company





Beach Club





Beach Club





Beach Club













Beach Club





Main Aft Deck





Main Aft Deck





Main Aft Deck



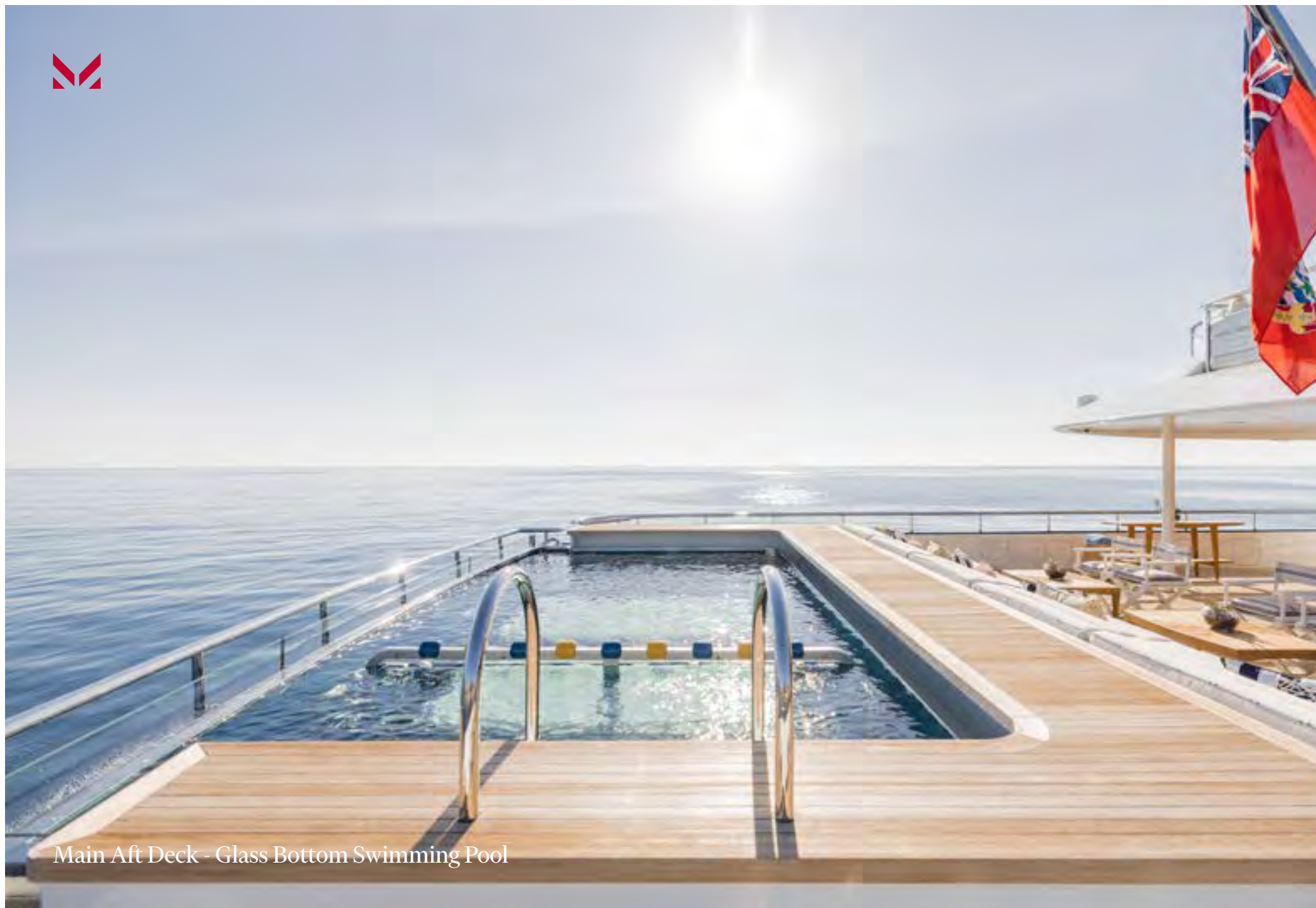

Main Aft Deck - Glass Bottom Swimming Pool





Main Salon





Main Salon





Main Salon





Master Stateroom





Master Stateroom





Master Stateroom





Master Bathroom





Master Bathroom





Master Bathroom





Owner's Study





VIP Cabin





VIP Cabin



VIP Cabin Bathroom





Main Deck - Double Port Cabin 1



Main Deck - Double Port Cabin 2





Main Deck - Double Port Cabin 2 Bathroom



Main Deck - Double Port Cabin 3





Main Deck - Double Starboard Cabin 1



Main Deck - Double Starboard Cabin 2





Main Deck - Double Starboard Cabin 2 Bathroom



Main Deck - Double Starboard Cabin 3





Lower Deck - Double Port Cabin



Lower Deck - Double Port Cabin Fwd





Lower Deck - Double Port Cabin Fwd Bathroom



Lower Deck - Double Starboard Cabin





Lower Deck - Cinema Room



Lower Deck - Cinema Room





Upper Deck - Spa







Upper Deck - Dining





Upper Deck - Dining





Upper Deck - Aft



Upper Deck - Aft





Bow



Bow







Sky Lounge





Sky Lounge



Bridge Deck - Aft





Sun Deck



Sun Deck





Sun Deck



Sun Deck - Jacuzzi





Sun Deck - Jacuzzi



Elevator





Elevator





Bridge















## MAIN SPECIFICATIONS

### Type

Twin Screw Diesel Yacht

### Flag

Cayman Islands

### Dimensions

Length O.A. 85.65m (281ft)  
 Length W.L. 72.50m (237.8ft)  
 Beam 12.4m (40.7ft)  
 Draft 3.45m (11.3ft)

### Tonnage

Gross 2,150

### Year Built / Refit

2009 / 2019 (extension) / 2022

### Builder

Abeking & Rasmussen, Germany

### Naval Architect

Abeking & Rasmussen

### Interior Designer

Reymond Langton Design/Winch Design

### Owner's Interior Designer & Decorator

Brian Callahan

### Exterior Designer

Reymond Langton Design

### Construction

Steel hull, aluminium superstructure, teak decks

### Classification

Lloyds Register  
 100A1 SSC Yacht (P) Mono G6  
 LMC UMS

## MACHINERY

### Main Engines

2 x Caterpillar 3516 b-DI TA S.C.A.C. Series II  
 1,492 KW at 1600 rpm

Engine Hours - 30 June 2022	Current total running hours	Next basic service due at	Hours at last full overhaul
Main engine- Port	13,296	13,000	11,000
Main engine - Starboard	13,297	13,000	11,000

### Gearboxes

2 x Reintjes WAF763, Ratio: 4.037:1

### Shafts

2 x Simplex oil bath through the hull  
 Balanced checked 11th March 2019

### Propellers

Schafraan Fixed Pitch Propeller, 5 Blade  
 Balanced checked 11th March 2019

### Speeds & Fuel

16.5 knots maximum speed  
 15.0 knots cruising speed  
 13.5 knots economical speed

### Consumptions

16.5 knots - 194 USG / 734 L per hour  
 15 knots - 139 USG / 528 L per hour  
 13.5 knots - 122 USG / 460 L per hour

Main Generator included in the above  
 21 USG/hour 80 ltr/hour

### Range

Fuel capacity taken from tank plan using 98% of capacity:  
 228 m3 Range calculated from full to empty

nm at maximum speed  
 6,475 nm at cruising speed 15 Knots  
 6,690 nm at economical speed 13.5 knots

## AUXILIARY MACHINERY & ELECTRICAL SYSTEM

### Main Generators

Three main generator sets, main data for each set as follows:

### Electric Power

515 kVA

### Diesel Engine

Caterpillar

### Type

C18 DITA

### RPM

1500

### Power

438 kW (according to ISO-3046/I)

Hours - 30 June 2022	Current total running hours	Next basic service due at	Hours at last full overhaul
Generator 1	26,849	25,000	20,000
Generator 2	25,097	24,750	20,000
Generator 3	27,126	24,750	20,000

### Emergency Generator

One emergency generator set:

### Electric Power

Three main generator sets, main data for each set as follows:

### Electric Power

105 kVA

### Diesel Engine

Caterpillar

### Type

3056 DIT

### RPM

1500

## AUXILIARY MACHINERY & ELECTRICAL SYSTEM (cont)

### Power

92 kW (according to ISO-3046/I)

### Emergency Generator Hours

64 hours

### Electrical

440 volts 3 phase 50 Hz electricity and 12 / 24volts DC.  
The switchboards are by SAM ELECTRONICS and generator synchronization by ASI Controllers.

### Shore Power

Atlas shore power system rated at 300 amps  
Input: 350 to 500 Volts AC, three phase, 50 or 60 Hz  
Output: 400/230 Volts, 3 phase, 4 wire, 361 amps, 50 Hz  
Power: 250 kVA

### Batteries

24 volt ship service  
24 volt radio room  
24 volt emergency generator start  
24 volt main engine and generator electronics  
24 volt centerline primary generator start

## TANK CAPACITIES (approximate)

### Fuel

Nine integral tanks 59,500 +/- US Gallons, 225,000 liters

### Water

Two (2) integral tanks, 16,600 US Gallons, 200,000 liters

### Watermakers

Two (2) HEM 24m<sup>3</sup>/ day (6,340 USG 24,000 litres/day)

### Clean Lub Oil

793 USG, 3,000 litres

### Dirty Lub Oil

1,490 USG, 5640 litres

### Grey Water

2 tanks totalling 7,230 USG 27,370 litres

### Black Water

1,900 USG, 7,192 litres

## ANCILLARY EQUIPMENT

### Steering System

Hydro Control with 2 x 4Kw motors acting on 2 x hydraulic cylinders

### Rudder Angle Indicators

Anchuntze

### Bow Thruster

Schottel, Fixed Propeller 185 kW, 440 volts 3 phase 60 cycle

### Stern Thruster

Shottel, Model SPJ57RD, Rotating Jet 220kW, 440 volts 3 phase 60 cycle

### Stabilizers

Quantum Marine, XT HD 1800, Four (4) extending fins zero speed capabilities

### Fuel Oil Separator

1 x Alpha Laval model MAB 1047

### Oil/Water Separator

1 x Thyssen Krump, Model Turblo 15ppm

### Bilge Pump

2 x Allweiler N140-250 28m<sup>3</sup>/hr

### Fire Pump

1 x Allweiler N140-250 28m<sup>3</sup>/hr

### Boilers

2 x 212 USG 2 x 800 litres

### Sewage Treatment

One (1) integral tank, 1,900 US Gallons  
Model DVZ BIOMASTERDVZSKA60  
60-person capacity  
The treatment system has been provided with a DVZ polishing and conditioning system on the discharge

### WC's

36 x Evac toilets



## ANCILLARY EQUIPMENT (cont)

### Air Conditioning

The vessel has been provided with a chilled water loop air conditioning system  
 Summer - Outside: 35C with 90% relative humidity  
 Summer - Inside: 21C and 40/60% relative humidity  
 Winter - Outside: 0C  
 Winter - Inside: 23C  
 Manufacturer: Drews Marine Germany  
 Refrigerant model R407C  
 Capacity: 115kW on each compressor  
 Compressors: Four (4) Bitzer semi-hermetic compact screw  
 Condensers: Four (4) Bitzer shell and tube  
 Evaporators: Two (2) Alfa Laval double circuit plate  
 Water Circulating Pump: Three (3) 32m<sup>3</sup> / hr. each  
 Raw Water-Cooling Pump: Two (2)

### Ventilation

Drews Marine 5 interior air handlers

## SAFETY & SECURITY EQUIPMENT

### Safety

Liferafts 4 x 25pax Hydrostatic plus 4x 12pax manual  
 Rescue tender, see under tender listing  
 Life jackets - 80, Child - 13  
 Immersion suits - 70  
 EPIRB - 1  
 Flares - 2  
 EEBD - Drager Saver CF 15 x 9  
 SARTS - 2  
 GMDSS Radios - 4  
 Smoke Hoods - 77  
 Line Throwing Devices - 4  
 Rotheta RT 300 Man overboard beacon direction finder

## SAFETY & SECURITY EQUIPMENT (cont)

### Medical

Cat A MedAire Kit  
 Robinson stretcher  
 Floating stretcher

### Fire Figthing

27 Hydrants and 27 Hoses  
 Sprinkler system throughout vessel  
 Engine room CO2 system  
 Galley CO2  
 2 x Böning touch screens for fire doors and watertight doors  
 BA Kits x 5 (+ spares)

### Alarms & Monitoring

Engineering alarms are monitored through a central system directed to Dect or smart phones through the SIP PABX system to the crew

### Steward Call

Steward call is via fixed buttons or iPad's and are relayed to either Dect or smart phones with the crew via the SIP PABX system

### Security

Security system including keypad entry to crew entrance, motion sensors on main and upper decks, security and monitoring cameras on main deck, beach deck (hidden x2), mast, engine room, fwd. machinery space, Tender Garage.

Monitored in security cabin, crew messes, bridge and engine control room. Recording facility included.

Two (2) Sanshin spotlight controllers

## COMMUNICATION EQUIPMENT

### Satcom

Sailor FB500  
 Sailor 6018 Sat Com C / Message Terminal

### Cellular System

2N Telecommunications EasyGate GSM  
 Gateways for 3 cellular phone lines

### VHF Radiotelephones

Sailor VHF radio  
 Raytheon Anschutz RT 5022 VHF/DSC radio

### Telephone

Panasonic KX-TDE600

### Exchange

Office 365 Mail Server

### UHF Communications

Motorola Marine Tetra System new 2018

## NAVIGATION EQUIPMENT

### Magnetic Compass

Cassens and Plath magnetic compass

### Gyro Compass

2 x Anschutz STD 22. Last sphere change Oct 2015

### Automatic Pilot

Anschutz Nautipilot NP 2025

### Log

Skipper EML224 speed log

### Echo Sounder

Skipper GDS 101 Echo sounder

### Radar

Starboard screen Raytheon Synapsis radar X band 64 miles.  
 19 inch screen Port side Ratheon Synapsis radar X band  
 64 miles, 19 inch screen

## NAVIGATION EQUIPMENT (cont)

### Chart Plotter

Raytheon full ECDIS - Synapsis system 2019 Primary 25inch Screen, integrated to radars Raytheon 2nd Synapsis ECDIS to 19 inch screen Raymarine E touch 12 inch chart plotter

### GPS

Two (2) Saab model R4 navigation system with GPS

### Navtex

Furuno Navtex receiver model NX7000

### Wind Instruments

Brooks & Gatehouse model H3000 for speed, wind, sea temp, air temp and navigation

### AIS

Saab model R4 AIS System integrated to ECDIS

## DECK EQUIPMENT

### Anchor Windlass

Two (2) Steen type 23-9-14 440 Volt 3 phase 50cycle

### Aft Warping Capstans

2 x Steen model 59-9-10, 440 Volt 3 phase 50cycle

### Ground Tackle

Two (2) 1,885 lbs. Poole type anchors with 30mm thick chain 7 shackles in length each side. Chain new 2016

### Boat Crane & Davits

Foredeck Crane - 2500SWL. Gilbert Schmalriede Rescue Crane. Tender Garage 2x full length davit cranes w/ 3x 2t lifting points

### Passerelle

Starboard Quarter. Extending / rotating capabilities. Stainless stauncions. 'Runway' effect LED lighting. Removed 2019 extension for service and painting.

### Side Boarding Ladders

## DECK EQUIPMENT (cont)

### Side Boarding Ladders

Starboard hydraulic guest boarding ladder removed 2019 extension for painting and service

### Swimming Platform

Awning, shower and stern tender fendering

### Awning

Large Sundeck Aft, Small Sundeck Forward over Jacuzzi, Medium Bridge Deck Aft over eating, Medium Upper Deck Aft over seating, Small Upper Deck Forward over owners lounge, Main deck over seating and small triangular over pool

## AUDIO/VISUAL ENTERTAINMENT SYSTEMS

All guest cabins and common areas have music audio available through Central Sonos, Apple Airplay and Request Music Server.

### Main Salon

iPad for control of room AV system consisting of Projector and Motorized Projection Screen. Sources available are Satellite TV, Kaleidescape Movie Server, Apple TV, Blu Ray Player and Passenger Information System.

### Bridge Deck

iPad control of AV system, 85 inch Samsung TV, Sources available are Satellite TV, Kaleidescape Movie Server, Apple TV, Blu Ray Player and Passenger Information System

### Lounge

iPad for control of room AV system, 75 inch Panasonic TV. Sources available are Satellite TV, Kaleidescape Movie Server, Central Apple TV, Blu Ray Player, Passenger Information System, Xbox One Game Console and Playstation 4 Game Console

### Sun Deck

iPad for control of exterior AV system, Speakers linked to Central Audio System consisting of Sonos, Request Audio Server and Apple Air Play.

## AUDIO/VISUAL ENTERTAINMENT SYSTEMS (cont)

### Owners Cabin

iPad for control of room AV system, 77" 4K LG TV Bang & Olufsen system speakers, Sources available are Satellite TV, Kaleidescape Movie Server, Apple TV, Blu Ray Player, Passenger Information System

### Guest Cabins

iPad for control of room AV system, Panasonic KX-DT543 analogue phones, 55 inch Panasonic TV, Oppo Blu-ray Player, Denon AVR-X3400H Receiver

### Captain's Cabin

iPad for control of room AV system, 43 inch Panasonic TV, Sources available are Satellite TV, Kaleidescape Movie Server, Local Apple TV, Blu Ray Player, Passenger Information System and CCTV Monitoring

### Crew Cabin

None

### Crewmess

iPad for control of room AV system Monitors for Panasonic CCTV, 55 inch Panasonic TV, Sources available are Satellite TV, Kaleidescape Movie Server, Central Apple TV, Blu Ray Player

### Galley

Speakers linked to Central Audio System, Crestron Keypad controller

### Laundry

None



## DOMESTIC EQUIPMENT

---

### Bridge Deck

Brother printer, scanner copier. Xerox work center 7225i printing machine

### Crew Mess

Xerox work centre printer, scanner copier

### Computers

Seperate inventory to be supplied

## DOMESTIC EQUIPMENT

---

### Main Galley

4 x Foster stand-alone refrigerator and freezer  
 1 x Winter Halter commercial dishwasher  
 2 x MKN 4 burner induction ranges  
 2 x Rational programmable combi ovens - 2017  
 2 x MKN deep fat fryer  
 2 x MKN Griddle flat tops  
 Panasonic Pro II microwave  
 Stainless steel and granite counter tops  
 1 x Foster stand-alone refrigerator  
 1 x Foster under counter refrigerators 3 doors  
 1 x Foster under counter ice machine  
 1 x Alfamix food processor  
 1 x Robot Coupe food processor  
 1 x Robot Coupe juicer  
 1 x PacoJet ice cream machine

## DOMESTIC EQUIPMENT (cont)

---

### Laundry

2 x Commercial Miele washing machines  
 2 x Commercial Miele tumble dryers  
 3 x Miele Professional washers  
 3 x Miele Professional Dryers  
 1 x Professional steam irons  
 1 x Miele roller press  
 1 x Lelit steam iron  
 1 x Speed Press Praktika steam iron  
 Custom walk in refrigerator with freezer inside  
 New 2019 Extension

### Pantry

#### Galley Pantry

2 x Winter Halter under counter dishwashers  
 1 x Hoshizaki under counter Ice machine  
 1 x Foster under counter freezer  
 1 x Foster under counter beer cooler  
 1 x Foster full height drinks cooler  
 1 x Nespresso double unit coffee maker  
 Dumb waiter servicing four (4) decks from bridge deck to tank deck

#### Main Deck Pantry

1 x Foster full height beverage cooler  
 1 x Foster ice machine  
 1 x Winter Halter dish washers  
 1 x Full height wine cooler  
 1 x Nespresso machine

#### Bridge Deck Pantry

1 x Winter Halter dish washer  
 1 x Foster under counter ice machine  
 1 x Foster full height refrigerator  
 1 x Bravilor Bonomat Coffee machines  
 1 x Nespresso coffee machine

#### Lower Deck Pantry

2 x Foster stand alone refrigerators  
 3 x Eurocave 120 bottle wine coolers  
 Various counter top appliances

## DOMESTIC EQUIPMENT (cont)

---

### Dry Storage

1 x Foster full height refrigerator  
 1 x Eurocave wine cooler

### Crew Mess

Foster ice machine  
 2 x Foster under counter refrigerators  
 2 x Miele Professional dishwashers  
 2 x Bravilor Bonomat Coffee machines  
 1 x Panasonic Pro II microwave  
 1 x Foster full height beverage cooler

### Sundeck

1 x Foster stand alone fridge in bar

### Upper Deck

1 x Foster stand alone fridge in bar

### Bridge Aft Deck

1 x Foster stand alone fridge in bar

### Dive Store

1 x Miele PT7135 Dryer  
 1 x Miele PW6065 Washer

## OTHER EQUIPMENT

---

### Jacuzzi Dip Pool

Sundeck forward

### Swimming Pool

Main deck aft

### Ship's Safes

Office and skippers cabin

### Elevator

All guest decks and sundeck

### Gym Equipment

No formal gym, separate inventory list

## TENDERS & WATER TOYS EQUIPMENT

### Tenders

#### 2 x Custom Tenders

Manufacturer: YachtWerft Mayer  
 Built: July 2008, re-engine 2018,  
 Length: 20.25 ft  
 Beam: 9 ft  
 Power: 2 x Volvo Penta model D30-160-A rated at 163hp

Hull ID No's. /engine Hours:  
 DE-YWMTS042G808 / 211 hours (30/06/2020)  
 DE-YWMTS043G808 / 185 hours (30/06/2020)

#### 1 x Rib

Manufacturer: Pirelli Pzero T75  
 Built: 2020  
 Length: 7.5m  
 Width: 2.5m  
 Power: VolvoPenta D3 220hp/DP-S

Hull ID No./Hours: IT-TCBT7505A020  
 48.2Hours (30/06/2020)

#### 1 x Rescue Tender

Manufacturer: Zodiac  
 Model No.: RID420  
 Hull ID No.: HDC3067FF708  
 Power: 40hp SOLAS Outboard

### Water Toys

5 x battery powered water scooters  
 3 x jetskis seadoo (2x RXP-X RS and 1x GTR)  
 3 x seabobs F5-SR Black  
 2 x illiptical paddle boards  
 2 x SUPs with paddles  
 2 x Kayaks

### Other Sports Equipment

See inventories for further details

## ACCOMMODATION

### Accommodation for 22 guests in 11 cabins

#### Owner

Owners cabin Upper deck forward with panoramic forward windows. Accessed via private corridor and with two further doors to the upper deck forward outside deck. King size bed his and hers bathroom and dressing rooms. Two children's cabins also within the private corridor with bathrooms and additional Pullman bed over single beds.

#### Guests

#### 11 double cabins consisting of:

##### Lower deck

4 x cabins king sized beds

##### Main deck

1 x VIP Cabin King sized bed.  
 2 x Cabins King sized beds  
 2 x Cabins King sized beds with additional access directly to main deck exterior.  
 2 x Cabins Queen sized beds  
 Upper deck (Owners deck)  
 1 x Cabin double  
 1 x Occasional cabin / TV room

#### Staff

##### Sun deck

1 x single cabin with shower and toilet

##### Upper deck

1 x Security cabin, 2 x bunk beds with bathroom

#### Crew area

2 x twin bunk staff or crew cabins

#### Crew

27 crew including skipper consisting of  
 10 crew cabins  
 1 chief engineer cabin  
 1 chief officer cabin  
 1 Skippers cabin

## EXCLUSION LIST

Available upon request



## WORKS LIST

---

### 2022

- 2022 refit €4 Million, Interior Refit designed by WINCH DESIGN
- New upholstery and artwork
- New exterior and interior furniture
- General maintenance

### 2021

- AMS: Alarm Monitoring System fully replaced with new RH Marine system, to include all hardware, software, mimic panels. Installed by Tess Marine LLC, Florida
- Generators: 3 x generator mechanical end. 5,000 hour major service. Top end rebuilds, auxiliary items exchanged or renewed, heat exchangers etc. Carried out by CAT dealer Performance Power Systems, Florida
- Generators: Major works on Centre and Starboard, complete electrical ends (alternators) replaced with new. Performance power and Rybovich
- New standalone freezer fitted in Galley
- General maintenance

### 2020

- April New Pirelli P Zero T75 Rib
- PABX system SIP upgrade for alarm messages to smartphones

### 2019 - Abeking & Rasmussen

- Extension to include pool, beach deck, tender garage and steering gear rooms, garbage room, amend main deck pantry and lounge arrangement to add 2 cabins
- Upgraded stabilizer system with new Quantum XT system zero speed fins
- Changing main engine crank shaft seals, shaft thrust bearings and Vulkan bearing
- 10-year service of gear boxes
- Centre generator rebuild
- Side boarding ladder and stern gangway, stripped and painted
- New walk-in fridge freezer built, existing compressors and evaporators serviced
- Stern thruster 10-year service
- Upgrade of security system
- Install 2 x new X band radars
- Tanks - Grey, black and fresh recoated
- TVRO 120cm antenna replaced
- Full hull underwater blasting and recoating

### 2019 - Palma

- Paint (Pinmar)
- Mast base and monkey island
- Sun deck interior and exterior bulwarks and visor, excluding Jacuzzi area and flats
- Bridge deck exterior bulwarks and visor
- Bridge deck house complete except for the aft face

### 2019 - Palma (cont)

- Upper deck exterior bulwarks
- Upper deck exterior house aft complete
- All exterior bulwarks will include the horizontal top surface to the outboard edge
- Raytheon Synapsis system updated to latest system requiring 2 x new Radar pedestal mast units
- Upgraded the old 6004 TVRO Antenna to the new Seatel I20 HD TVRO Antenna
- Projector Screen and Projector Main Salon, Installed in Trinnov Receiver for optimised Audio
- Upgraded the MD AFT B&W Speakers to James Speakers and added additional surround speakers and sub-woofers
- Installed Beach Club AV System. Including TV, Crestron Control and Speaker Configuration
- Upgraded Old Sun Deck Speakers to James Loudspeakers for enhanced Audio
- Upgrade to Office 365 email server solution
- Upgraded from QNAP NAS and Installed HP MSA SAS Dual Controller to store all VM data Stores
- Installation of MiMo 4G Router to add additional redundancy with Pepwave 4G Max HD4 Router
- Added 2 extra local Apple TV's to SOP and CSP Cabin and extra Apple TV in ROP Cabin. Installed QNAP NAS to store all Apple content for Home sharing on iTunes
- Upgraded Panasonic Analog CCTV to Panasonic IP CCTV. Including 14 IP Cameras and 3 CCTV workstations in Bridge, Crew Mess and ECR

## WORKS LIST (cont)

### 2018 - Refit MMLC - La Ciotat

- VSAT upgraded
- Tetra Radio installation
- Main engine top end overhaul
- Paint touch ups to inboards and outboards
- Engines, shields, legs, looms etc. of both custom tenders replaced with new (4x full engine sets)
- Raytheon 1 x Radar X band pedestal unit replaced
- Replaced all Linn Basik3 wall keypads with Crestron C2NI-CB-B-T Keypads
- Replaced all Linn Amplifiers with Crestron Swampie Multi Zone Amplifiers. Added additional Crestron PRO 3 processor to share load of existing Pro 3. Installed Additional Crestron CP3's in Owners, Projector Lounge(Main Salon), Sky Lounge and MD Aft
- Installed Local Blu-Ray Players in Cabins 5, 6, 7 and 8
- Upgraded old Seatel 6006 VSAT antenna to new Seatel 6012 KU Antenna
- Upgraded the Cisco Network backbone speed to 40Gb/s but using Fibre connections between switches. Upgraded WLAN Controllers to Cisco 3500 Series
- Upgrading of old UHF System to Tetra UHF Radio System. Includes 4 antennas, Tetra Controller and Transceiver 4 Time slots for private calling and Licence for 50 radios. 14 x Tetra Marine Slim Line ST7000 radios and 18 x Tetra Marine MTP3550 Radios

### 2017 - Refit MMLC - La Ciotat

- 2 x Generator rebuilds
- Pinmar paint works to foredeck complete and inboards general touch ups
- Raytheon 2 x ECDIS synopsis systems
- Installed Crestron DM-MD64x64 HD Matrix, Including 8 x Crestron DMB-4K-IHD Input Cards and 5 x DMB-4K-O-C Output Cards. This allows routing of any input (Source) to any Output (Cabin) around the vessel
- Installed 16 Panasonic new TV's in the Guest Cabins.
- Installed Kerio NG500 Firewall appliance and integrated Pepwave 4G Max HD4 Router and VSAT for hot failover solution. Optimised Cisco Switch Stack Configuration and Virtualisation of all Servers DC, DHCP, Techman etc

### 2016 - Refit MMLC - La Ciotat

- Pinmar paint works, all blue hull
- Raytheon 2 x Synapsis Chart radars installed plus 5 new TFT screens
- LED Lighting Upgrade. Installed KNX System with dimmer modules to allow iPad control of Guest Cabin and common guest area lighting and blinds using Crestron integration

### 2015 - Refit MMLC - La Ciotat

- Pinmar paint works, all white outboards of superstructure painted
- Generators. Major works on Port unit, complete electrical end of set (alternator) replaced with new. Works completed by A&R and Pon Power in La Ciotat
- Raytheon Radar Antennas replaced
- Steward Call and Alarm System Upgrade. Installed WAGO Pro 32 and Dell Server for Poltys Alarms Software. Allowing for system integration between Alarms and Panasonic PBX to receive on DECT phones

### 2014 - Refit

- Pinmar paint works to foredeck complete and main deck inboards general touch ups

### 2013 - Refit

- Pinmar paint works, all blue hull.

### 2012 - Refit - MB92

- Convert 2 x fwd main deck VIP cabins into 4 x smaller cabins
- Conversion of Jet ski storage to staff / crew cabins
- Paint repairs to hull and superstructure at MMLC La Ciotat

### 2009 to 2011 general maintenance works

These particulars have been prepared from information provided by the sellers and are intended as a general guide to the vessel. We cannot, however, be liable for any inaccuracy. It is up to the purchaser to confirm details of concern to him by survey, inspection and/or enquiry of the seller and to ensure that the purchase contract properly reflects his concern and specific details upon which he may rely. We always advise an independent survey.



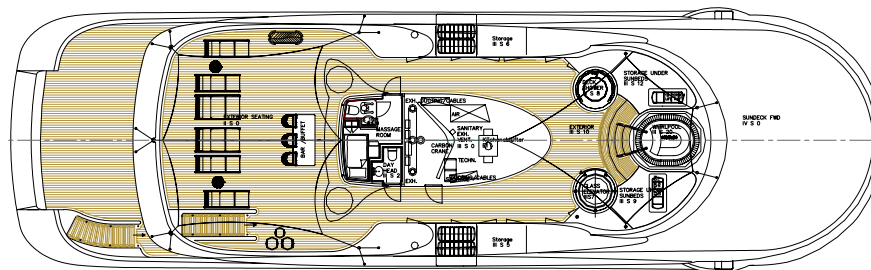

SUN DECK

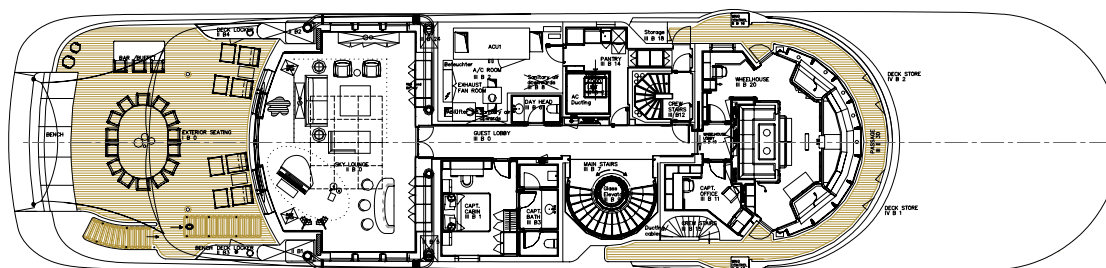

BRIDGE DECK

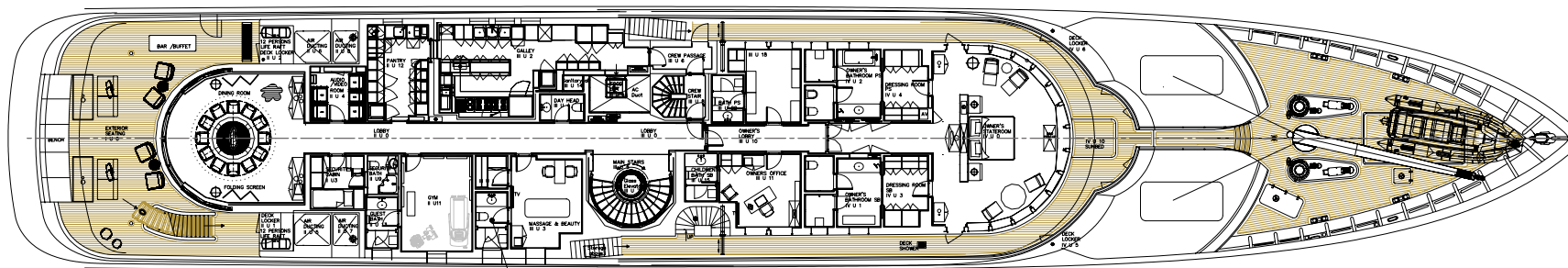

UPPER DECK

# General Arrangement

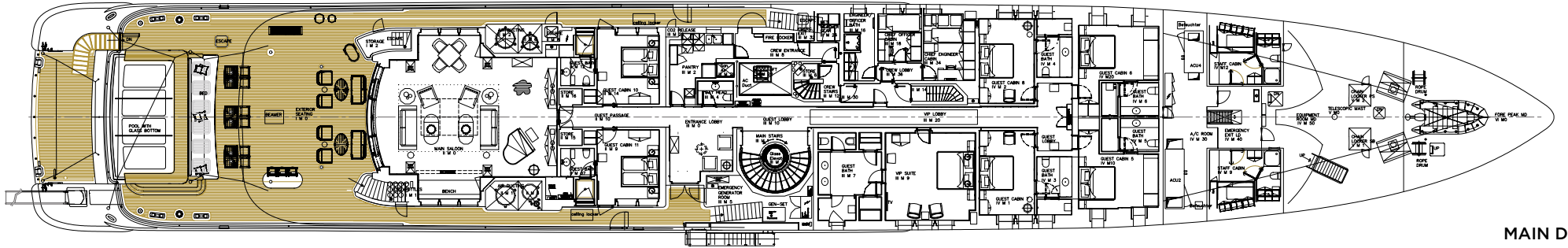

MAIN DECK

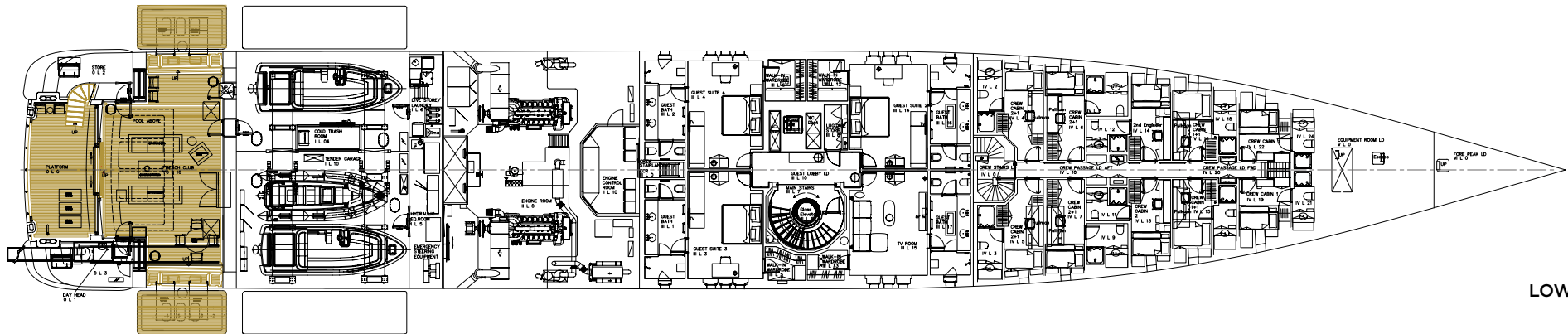

LOWER DECK

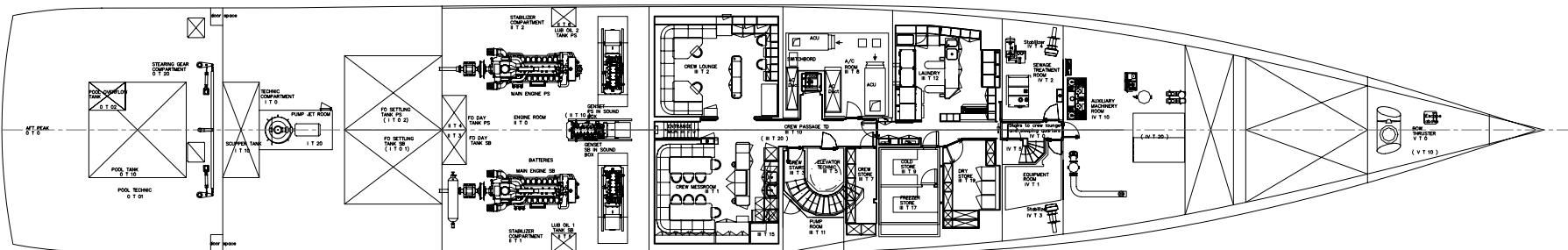

TANK DECK





Moravia  
YACHTING



## Contact

+377 93 10 29 29  
[moraviayachting.mc](http://moraviayachting.mc)

While every effort has been made to ensure that the information contained in this document is accurate as at the date of production, the accuracy of such information cannot be guaranteed. Moravia Yachting gives no representation, warranty or undertaking, express or implied, as to: the accuracy, reliability, completeness or reasonableness of the information contained in this document; the condition of a featured yacht and/or its equipment; the seaworthiness of a featured yacht; or the suitability and/or availability of a featured yacht for purchase or charter. The fees, specifications, figures, images and comments included in this document are subject to change without notice. This document has been produced by Moravia Yachting at the request of the person identified on the front cover for discussion purposes only and is confidential. This document must not be copied or distributed to any third party, in whole or part, without Moravia Yachting's express written permission. Moravia Yachting hereby expressly excludes any liability howsoever arising in respect of any inaccuracies or errors in the information contained in this document, to the fullest extent permitted by law.