



# Moravia

YACHTING

## ASGARD

Builder	Abeking & Rasmussen
Year/Refit	1993/2021
LOA	42.84m (140' 6")
Beam	8.4m (27' 9")
Draft	3m (10' 5")
Cabins	4
Guests	8
Speed	12/10 kts
Price	€8,900,000



A Hill Robinson Company



Salon



Salon



Master Bedroom



Dining Room



**Master Bedroom**



Master Bathroom



**Owner's Office**



**VIP Bedroom**



**Twin Bedroom**



Navigation Room



Sun Deck















Asgard



19

Abeking & Rasmussen









# Yacht Specifications

## MAIN SPECIFICATIONS

<b>Flag</b>	Virgin Island, British
<b>Length</b>	42.84m (140' 6")
<b>Beam</b>	8.4m (27' 9")
<b>Draft</b>	3m (10' 5")
<b>Gross Tonnage</b>	152
<b>Year Built</b>	1993/2021
<b>Builder</b>	Abeking & Rasmussen
<b>Naval Architect</b>	Bruce King Yacht Design
<b>Interior Design</b>	Winch Design
<b>Exterior Design</b>	Bruce King Yacht Design
<b>Hull Construction</b>	Wood sheathed in GRP (70mm thick planks)
<b>Superstructure</b>	Wood

## MACHINERY

<b>Main Engines</b>	1 x MTU 985 HP, 12V 183 TE92 (Full MTU W6 rebuild 2020/1 refit)
<b>Engine Hours</b> (July 2024)	28,890 Hours
<b>Gearbox</b>	Make ZF BW 195 ratio 2.571:1 (rebuilt 2020/1 refit)
<b>Shafts</b>	One
<b>Power</b>	985hp/ 735kW
<b>Propulsion</b>	Single screw propeller (Schaffran CPP)
<b>Speeds</b>	8-10 Knots under power, 190M p/d planning speed under sail/power
<b>Range Under Power</b>	1,680 nm

## AUXILIARY MACHINERY & ELECTRICAL SYSTEM

<b>Port Generator</b> (July 2024)	Northern Lights 30 kw; model number M1064D-33 kw
<b>Starboard Generator</b> (July 2024)	Northern Lights 50 kw; model number M6414D-501
<b>Generator Hours</b> (July 2024)	Port 7,487 Hours Stbd 3,356.5 Hours
<b>Electric Power</b>	3 phase 50Hz
<b>Electrical</b>	220v single phase
<b>Shore Power</b>	ASEA shore power transformer 50/60 Hz
<b>Batteries</b>	1 x main engine start, 1 x 30 Kw gen start, 1 x 50 kw gen start. Domestic: 4000 Ah (DC power bank for DC hydraulics) 48 2v cells (renewed 2020/1 refit)

## SAILING & RIGGING

<b>Rigging type</b>	Double headsail ketch
<b>Sail maker</b>	Doyle UK
<b>Sail total area</b>	680m <sup>2</sup>
<b>RIG Measurements</b>	Main mast 42m (keel stepped) Mizzen Mast 33m (keel stepped)
<b>Spars</b>	Southern Spars (Ultrasound survey 2020)
<b>Standing Rigging</b>	BSI
<b>Running Rigging</b>	Checked and replaced 2020 (THL)
<b>Furling Gear</b>	Reckmann
<b>Winches</b>	Lewmar (winches all serviced in 2020/1 refit by Lewmar)

## TANK CAPACITIES (approximate)

<b>Fuel Consumption</b>	960 liters - approximate
<b>Fuel Tanks x 5</b>	10,245 liters- total
<b>Fresh water x 2</b>	6,400 liters
<b>Grey/Black Water</b>	3 x Grey Tanks: Total 1,470 lts 2 x Black Tanks: Total 720 lts

## ANCILLARY EQUIPMENT

<b>Hydraulics</b>	2020/1 refit: all hoses replaced, PVG valves serviced, All HPU's replaced
<b>Bilge/Fire Pump</b>	Calpeda 4 Kw
<b>Air Conditioning</b>	Condaria
<b>Steering System</b>	Conventional wheel (cable & quadrant)
<b>Boilers</b>	2 x Calorifiers (1 Fwd 150 l1 Aft 150l)
<b>WC's</b>	Altena

These particulars have been prepared from information provided by the sellers and are intended as a general guide to the vessel. We cannot, however, be liable for any inaccuracy. It is up to the purchaser to confirm details of concern to him by survey, inspection and/or enquiry of the seller and to ensure that the purchase contract properly reflects his concern and specific details upon which he may rely. We always advise an independent survey.

## SAFETY & SECURITY EQUIPMENT

### Safety

- 4 x liferings
- 2 x MOB smoke floats
- 2 x Jon Buoys
- 15 x immersion suits
- 25 x inflatable lifejackets
- 2 x IPIRB's
- 2 x SARTS
- 2 x GMDSS emergency handheld radios

### Medical

MCA CAT A

### Fire

- 2 x firemen's suits and BA's
- 2 x hoses
- 4 x hydrants
- 23 x fire extinguishers
- 15 x heat and smoke detectors

### Alarms & Monitoring

- 3 x carbon monoxide detectors

### Security

- 4 x CCTV

## COMMUNICATION EQUIPMENT

<b>Satcoms</b>	Inmarsat C (Sailor 6006) VSAT (Sailor ACU)
<b>Cell/Wifi</b>	Pepwave, Yotspot
<b>VHF Radiotelephones</b>	2 x fixed, 2 x portable
<b>Telephone</b>	MF/HF Sailor 6300 DSC

## NAVIGATION EQUIPMENT

<b>Gyro Compass</b>	Raytheon STD 22 (serviced with new sphere 2021)
<b>Automatic Pilot</b>	AP70 Mk II
<b>Echo Sounder</b>	Furuno Fishfinder & Airmar DST
<b>Radar</b>	4g & Furuno X-band
<b>Chart Plotter</b>	Simrad & Maxsea Pro
<b>DGPS</b>	Saab R5
<b>Navtex</b>	Mcmurdo
<b>Wind Instruments</b>	B&G Hercules
<b>AIS</b>	Saab R5 class A
<b>Raytheon STD 22</b>	(serviced with new sphere 2021)

## AUDIO/VISUAL ENTERTAINMENT SYSTEM

- 2 x Yamaha AMPS
- 2 x AppleTV Blue Ray DVD
- 1 x Play-Station PS4
- 1 x Overhead projector
- 1 x Samsung 48" TV

## DOMESTIC EQUIPMENT

- 1 x Dishwasher
- 1 x Dryer
- 1 x Washing machine
- 1 x Oven and hob
- 1 x Microwave
- 1 x Vacuum cleaner
- 1 x Custom fridge and Freezer in galley
- 1 x Quooker - (instant hot water)
- 1 x JURA coffee machine

## TENDERS & WATER TOYS EQUIPMENT

### Tenders

- Zar Rib
- 70 hp Yamaha
- 4m Inflatable
- 25 hp Yamaha

## ACCOMODATION

<b>Cabins</b>	4 (1 Owner, 2 Double, 1 Twin)
<b>Guests</b>	8
<b>Crew</b>	Captain + 5
<b>Master Cabin</b>	Ensuite Double Cabin, 1 double bed
<b>Guests Cabins</b>	3 Double Cabins, x 2 single bed, 1 x double bed (separate toilets shared showers)
<b>Crew Cabins</b>	3 x Double Cabins, Bunk beds (separate toilets, shared showers)

## WORK LIST/REFIT

### 2021

Both generators and main engine were completely rebuilt back to zero hours at refit launch (May 2021)

## PRICE

€8,900,000

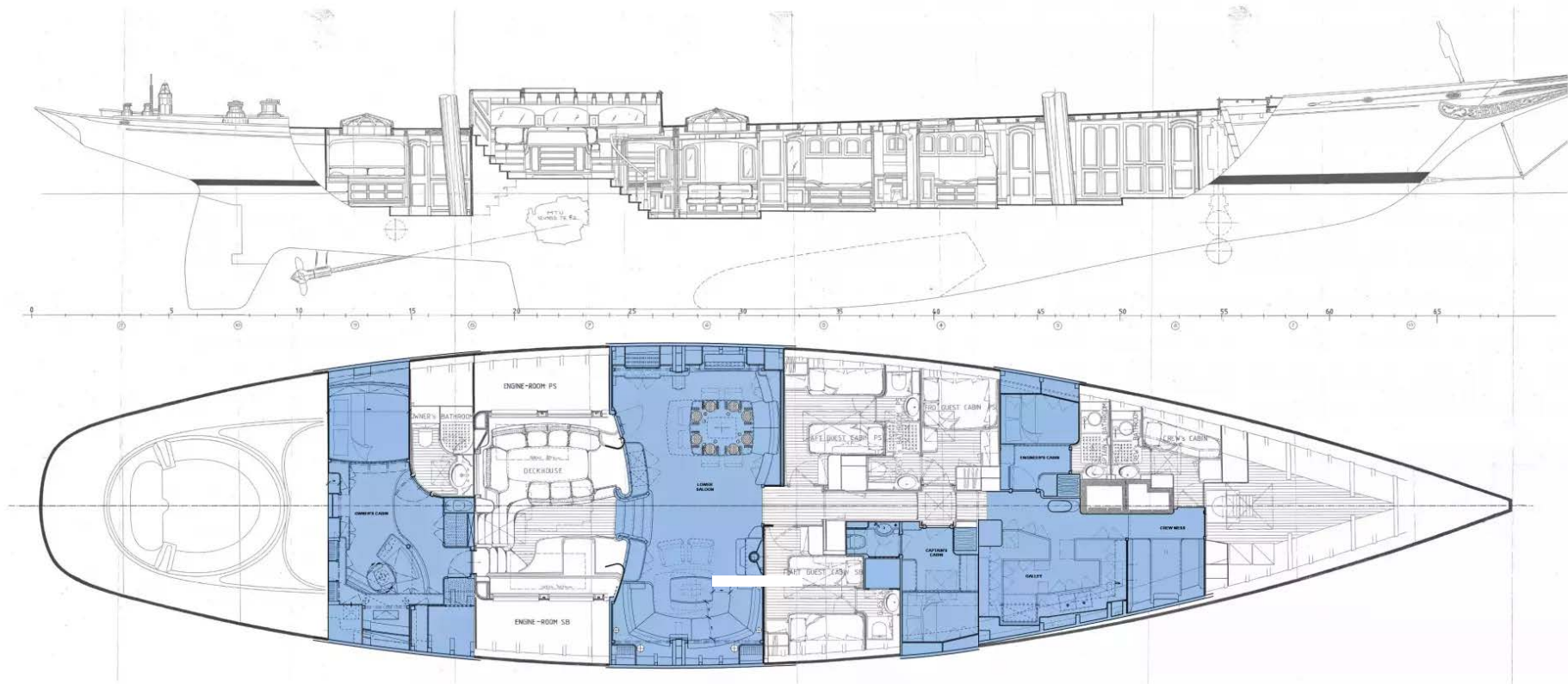

These particulars have been prepared from information provided by the sellers and are intended as a general guide to the vessel. We cannot, however, be liable for any inaccuracy. It is up to the purchaser to confirm details of concern to him by survey, inspection and/or enquiry of the seller and to ensure that the purchase contract properly reflects his concern and specific details upon which he may rely. We always advise an independent survey.



# Moravia

YACHTING

## Contact

**Sam Tucker**

Sales Broker

+44 7548 765406 | [sam.tucker@moraviayachting.mc](mailto:sam.tucker@moraviayachting.mc)

[moraviayachting.mc](http://moraviayachting.mc)

While every effort has been made to ensure that the information contained in this document is accurate as at the date of production, the accuracy of such information cannot be guaranteed. Moravia Yachting gives no representation, warranty or undertaking, express or implied, as to: the accuracy, reliability, completeness or reasonableness of the information contained in this document; the condition of a featured yacht and/or its equipment; the seaworthiness of a featured yacht; or the suitability and/or availability of a featured yacht for purchase or charter. The fees, specifications, figures, images and comments included in this document are subject to change without notice. This document has been produced by Moravia Yachting at the request of the person identified on the front cover for discussion purposes only and is confidential. This document must not be copied or distributed to any third party, in whole or part, without Moravia Yachting's express written permission. Moravia Yachting hereby expressly excludes any liability howsoever arising in respect of any inaccuracies or errors in the information contained in this document, to the fullest extent permitted by law.