



# Moravia

YACHTING



## Bartali

Builder	Wider
Year/Refit	2016
LOA	47.05m (154' 5")
Beam	8.6m (28' 3")
Draft	1.98m (6' 5")
Cabins	5
Guests	10
Speed	13/12 kts
Price	€19,800,000 Ex VAT

  
A Hill Robinson Company







Main Salon



Main Salon



Main Salon



Upper Deck - Dining



Master Stateroom





Master Stateroom - En Suite



Master Stateroom - Balcony



Master Stateroom - Balcony



VIP Cabin



VIP Cabin - En Suite



Twin Cabin



Twin Cabin - En Suite



Bridge



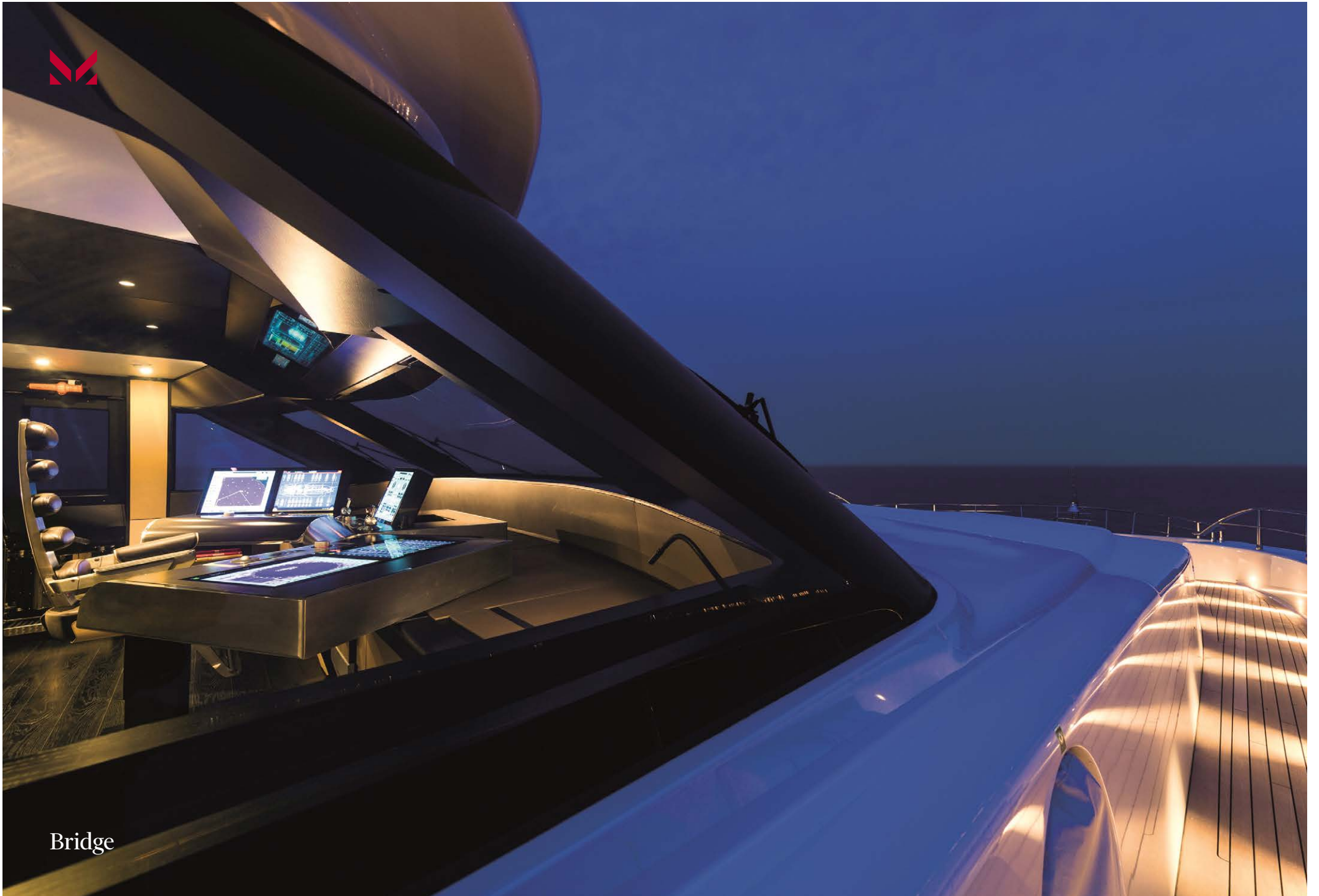

Bridge



Sun Deck



Sun Deck



Sun Deck - Jacuzzi



Main Deck - Cockpit



Main Deck - Cockpit



Upper Deck - Aft



Upper Deck - Aft





Fore Deck



Fore Deck



Beach Club















## MAIN SPECIFICATIONS

<b>Flag</b>	Cayman Islands
<b>Length</b>	47.05m (154' 5")
<b>Beam</b>	8.6m (28' 3")
<b>Draft</b>	1.98m (6' 5")
<b>Gross Tonnage</b>	484
<b>Year Built</b>	2016
<b>Builder</b>	Wider Yachting Srl
<b>Naval Architect</b>	Wider / Sydac
<b>Interior Design</b>	IdeaItalia, BB, Poltrona Frau, Paola Lenti
<b>Exterior Design</b>	Fulvio de Simoni
<b>Hull Construction</b>	Aluminium
<b>Superstructure</b>	Aluminium
<b>Classification</b>	RINA, MLC standard

## MACHINERY

<b>Main Engines</b>	Two rudder propeller pods VZ 450 CR made by VETH
<b>Consumptions</b>	100 lt/hr at 10kn 140 lt/hr at 12 kn 200 lt/hr at 14 kn
<b>Speeds</b>	Maximum speed - 13 Cruising speed - 12
<b>Range</b>	4,700 nm @ 10kn

## AUXILIARY MACHINERY & ELECTRICAL SYSTEM

<b>Generator</b>	4 x MAN D2876 Generators 350Kw each
<b>Generator hours</b>	Gen 1. 3726 Gen 2. 4025 Gen 3. 4499 Gen 4. 4010

## TANK CAPACITIES (approximate)

<b>Fuel Capacity</b>	45,000 litres
<b>Water Capacity</b>	12,000 lktres
<b>Dirty Lub Oil</b>	1,150
<b>Grey Water</b>	4,700
<b>Kitchen Grey Water</b>	3,450
<b>Black Water</b>	4,500

## ANCILLARY EQUIPMENT

<b>Steering System</b>	It's also operated by the same Azipod
<b>Bow Thruster</b>	Thrust 10 kN Electrical motor power 98 kW
<b>Stabilisers</b>	Najad Electric Fin Zero speed Stabilizers
<b>Fuel/Oil/Water separator</b>	<ul style="list-style-type: none"> <li>- Racor 751000 MAM-R fuel filters/water separators</li> <li>- One fuel purifier MIB 303 by Alfa Laval</li> </ul>
<b>Bilge</b>	<ul style="list-style-type: none"> <li>- 1550 lts 400 VAC 50 Hz 3 phase, bilge pump</li> </ul>
<b>Fire Pump</b>	<ul style="list-style-type: none"> <li>- Diesel emergency pump for bilge and fire</li> </ul>
<b>Boilers</b>	<ul style="list-style-type: none"> <li>- 2 x150 lt water boilers</li> </ul>

## Cooling Water System

- The glycol cooling system heat exchangers of the PMS electrical system and electrical motors made in Titanium plates

## Air Conditioning

- 400 VAC, 3 phase, 50 Hz reverse cycle marine chiller type model WM 150.002, maker Condaria 600.000 BTU

## SAFETY & SECURITY EQUIPMENT

### Safety

- Equipment for 12 guests and 9 crew as prescribed by flag

### Medical

- Medical kit

### Fire

- Fixed fire extinguishing system Polytechno Aerosol

### Alarms & Monitoring

- A General Alarm System shall be provided in compliance with the register requirement

## COMMUNICATION EQUIPMENT

### Satcom

- INMARSAT Standard C SAILOR TT3020C GMDSS compliance
- 1 Starlink unit

### VHF Radiotelephones

- RADIOTELEPHONE VHF SAILOR

### Telephone

- A programmable CISCO VOIP telephone system with two handsets wired VOIP telephones and 14 cordless telephones connected to the local WI-FI system No. 8 IPOD TOUCH

### UHF Radiotelephones

- RADIOTELEPHONE SSB SAILOR HF-6000

## NAVIGATION EQUIPMENT

---

### Navigation

- Navtex - FURUNO NX-700

### Integrated bridge control by TEAM ITALIA

- LCD monitor 19" IP 65 marinized
- LCD monitor 38" Stretch
- Monitor 16" ultra stretch installed in an overhead panel.
- Control system
- Conversion system
- Switching system

### Magnetic Compass

- Magnetic Compass Plath Jupier

### Gyro Compass

- C.PLATH Gyrocompass system NAVIGAT

### Automatic Pilot

- Micro-Processor controlled digital fully adaptive Self tuning heading control system NAVIS AP4000

### Log/Echo Sounder

- WIND / DEPTH / LOG SYSTEM Air Mod PB 200 WX multi Nemea system
- BB Echo sounder as back up
- BEN electromagnetic LOG system single axis

### Radar

- RADAR FURUNO BB, Mod. FR 2117

### Chart Plotter

- CARTOGRAPHY & CONNING SYSTEM
- CARTOGRAPHY SYSTEM with: o N°1 Processor unit RS6B
- Keyboard & mouse cord less
- Track ball
- Software TRANSAS NS 4000 ECS version (Cartography excluded)

### Wind Instruments

- WIND / DEPTH / LOG SYSTEM Air Mod PB 200 WX multi Nemea system
- Air temperature sensor
- Air pressure sensor
- Humidity sensor
- Wind data display repeater Location - Captain's cabin)

### AIS

- AIS System TRANSAS MT2

## SHORE CONNECTION

---

- Two shore connections, one each side installed with a connector/ isolation transformer.
- Frequency: 50/60 Hz v
- Voltage: 175/260 V and 248/168 A
- 350/520 V and 125/84 A
- Both shore connections have an aft automatic cable recovering mechanism.
- N°1 shore connection for the main tender, in beach area

## AUDIO/VISUAL ENTERTAINMENT SYSTEM

---

### Main Salon

- SONANCE LCR1 in-wall speakers - N°1 SUNFIRE HRS-8 active subwoofer

### Main Deck Cockpit

- SONANCE LCR1 in-wall speakers - N°1 SUNFIRE HRS-8 active subwoofer
- SONANCE VP 65 XT Audio speaker water resistance 7.7" - N°1 JL Audio subwoofer water resistance 10" - N°1 Mini iPad - N°1 Custom button wall command

### Wheelhouse

- YAMAHA NS IC400 ceiling speakers - Airplay audio device source (volume and on/off by touch panel) - N°1 Mini iPad

### Bridge Deck

- ASK external waterproof ( Ribbon + Woofer) -
- Slave audio Upper Deck saloon
- JL Audio Speakers water resistant 7.7"
- Custom button wall command

### Lounge upper deck

- SONANCE LCR1 in-wall speakers - N°1 SUNFIRE HRS-8 active subwoofer - TV Led 65" - Mini iPad + lifeproof cover - Dock station HDMI plug

### Sun deck

- JL Audio speaker water resistance 7.7"
- JL Audio subwoofer water resistance 10"
- Mini iPad -
- Power soft Amplifier
- Slave audio Upper Deck saloon

### Owner's Cabin

- SONANCE LCR 2 in wall speakers
- SUNFIRE HRS-8 active subwoofer
- TV Led 55"
- Mini iPad
- Dock station
- Apple TV with airplay
- HDMI plug

### Owner's Bath

- SONANCE VP 65 XT ceiling speakers

### Owner's Study

- SONANCE VP 48 speakers -
- TV Led 40" - Mini iPad - Dock station - Apple TV with airplay (shared with owner cabin) - HDMI plug - LAN plug

## AUDIO/VISUAL ENTERTAINMENT SYSTEM

---

### 2 x Guest Cabin

- SONANCE VP 48 ceiling speakers - TV Led 32" - Mini iPad
- Dock magnetic - TV Led 32" - Apple TV with airplay

### 2 x VIP Cabin

- SONANCE VP 48 ceiling speakers - TV Led 40" - Mini iPad
- Dock station - Apple TV with airplay

### Captain's Cabin

- YAMAHA NS IC400 ceiling speakers - TV Led 32" - Apple TV with airplay - Mini iPad - Dock station

### 4 x Crew Cabin

- YAMAHA NS IC400 ceiling speakers - Airplay audio device source

### Crewmess

- YAMAHA NS IC400 ceiling speakers - Mini iPad - Dock station - TV Led 28" - Apple TV with airplay

### Galley

- YAMAHA NS IC400 ceiling speakers

### Laundry Beach Area

- JL Audio speaker water resistance 7.7" - JL Audio subwoofer water resistance 10" - Mini iPad + lifeproof cover

### Satellite TV antenna

- SeaTel 3004 30" dish self-point auto-stabilizing antenna

### CCTV System

- 1 x Panasonic HD network recorder
- 1 x Dome external camera at the main deck cockpit
- 2 x Dome internal cameras:
- 1 x in the technical room
- 1 x in the engine room

## DOMESTIC EQUIPMENT

---

### Bridge Deck

#### Crew Mess

- 2 x Fridge-freezer KFN 37682
- 1 x Freezer FNS 37402
- 1 x Microwave oven MIELE M6032ED
- 1 x Dish washer MIELE - G6470 SCVi
- 1 x Wine cooler MIELE KWT 6321 UG
- 1 x Sink in stainless steel
- 1 x Garbage cooled storage 90 litre
- Water filtering system, produce still/sparkling drinking water

#### Main Galley

- 1 x Professional Dish Washer Samic
- 1 x Built-in oven MIELE - H6890BP
- 1 x Steam Oven MKN
- 1 x Induction MIELE - KM6395
- 1 x Deep Fryer MIELE CSI411 F
- 2 x Fridge Freezer BOSCH
- Wine Cooler
- Vacuum Pack Machine
- 1 x Corian top with two integrated sinks including flexible hose water tap
- 1 x stainless steel exhaust range hood, connected to the exhaust ventilator, with removable grease filters
- Water filtering system, produce still/sparkling drinking water

### Laundry

- 2 x MIELE - PW6065 6.5 kg washing machines
- 2 x MIELE - PT7135C 6.5 kg dryer machines
- 1 x Ironing MIELE - B2847
- 1 x sink in stainless steel + water tap with extendible head
- 1 x Large Freezer

### Sundeck

- 1 x Fridge with two drawers FRIGONAUTICA 90 LT
- 1 x Ice maker - Barline
- 1 x Sink and water tap
- 2 x BBQ ALPES INOX 543 BE

### Upper Deck

- 1 x Fridge with two drawers FRIGONAUTICA 90 litre
- 1 x Corian sink
- 1 x Ice maker - Barline

### Dive Store

- Compressor and dive tanks

## OTHER EQUIPMENT

---

### Jacuzzi

- Whirlpool Teuco C20 for four persons, on sundeck

### Swimming Pool

- Indoor seawater swimming pool in tender garage

## TENDERS

---

- William 275 rescue tender

## ACCOMMODATION

---

- Master Cabin on main deck with ensuite bathroom, wooden bathtub and separate shower. Walk in wardrobe, Owners study
- 2 x VIP Cabins with double bed with ensuite bathrooms and separate shower
- 2 x Guests Cabins one with double bed + 1 bunk bed, one with separate bed sliding together with ensuite bathrooms and separate shower

## WORK LIST/REFIT

---

- Completely repainted in winter 2022/23 at Cantieri Rossini Pesaro, with full awlgrip cycle
- Recorded regular maintenance as prescribed by single components manufactures

# General Arrangement

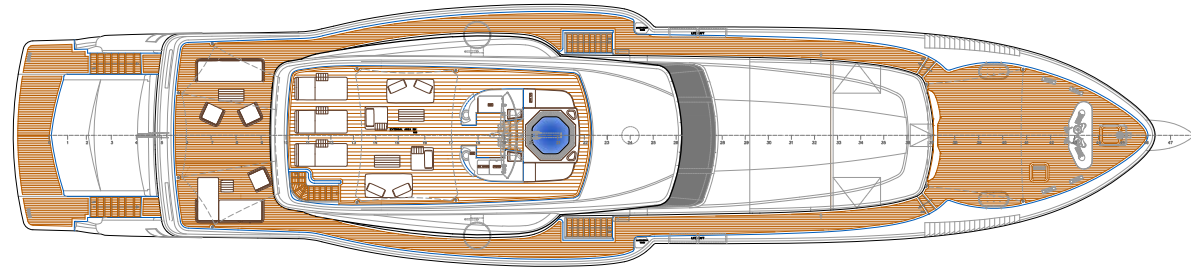

Sun Deck

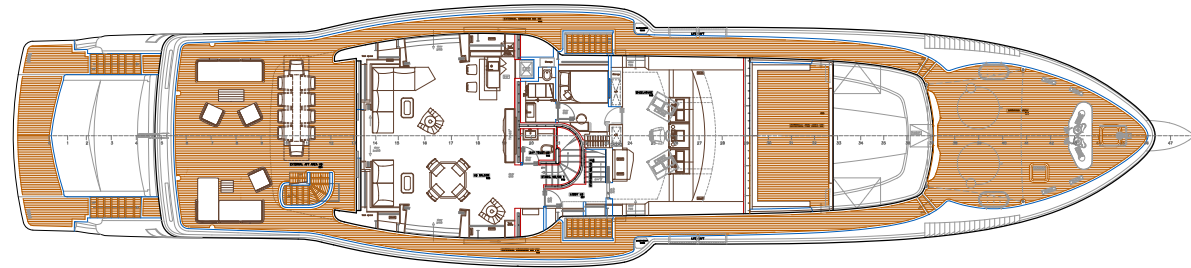

Upper Deck

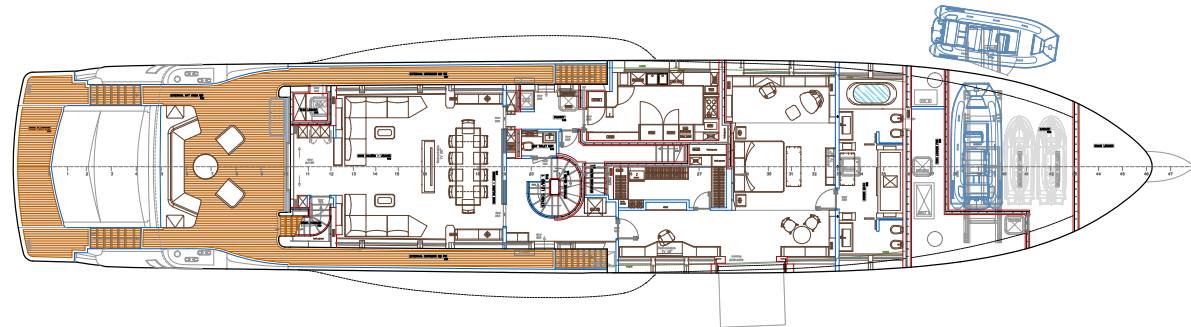

Main Deck

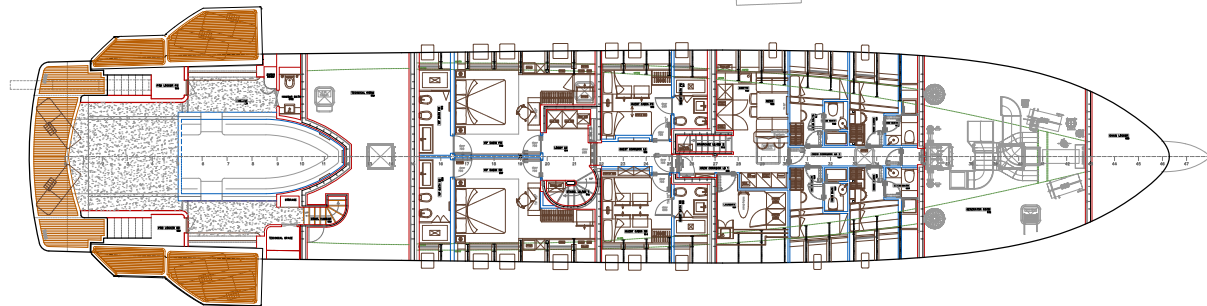

Lower Deck

These particulars have been prepared from information provided by the sellers and are intended as a general guide to the vessel. We cannot, however, be liable for any inaccuracy. It is up to the purchaser to confirm details of concern to him by survey, inspection and/or enquiry of the seller and to ensure that the purchase contract properly reflects his concern and specific details upon which he may rely. We always advise an independent survey.



# Moravia

YACHTING



## Contact

**Alessandro Diomedi**

Sales Broker

+377 6 43 91 90 54 | [alessandro.diomedi@moraviayachting.mc](mailto:alessandro.diomedi@moraviayachting.mc)

[moraviayachting.mc](http://moraviayachting.mc)

While every effort has been made to ensure that the information contained in this document is accurate as at the date of production, the accuracy of such information cannot be guaranteed. Moravia Yachting gives no representation, warranty or undertaking, express or implied, as to: the accuracy, reliability, completeness or reasonableness of the information contained in this document; the condition of a featured yacht and/or its equipment; the seaworthiness of a featured yacht; or the suitability and/or availability of a featured yacht for purchase or charter. The fees, specifications, figures, images and comments included in this document are subject to change without notice. This document has been produced by Moravia Yachting at the request of the person identified on the front cover for discussion purposes only and is confidential. This document must not be copied or distributed to any third party, in whole or part, without Moravia Yachting's express written permission. Moravia Yachting hereby expressly excludes any liability howsoever arising in respect of any inaccuracies or errors in the information contained in this document, to the fullest extent permitted by law.