



Moravia

YACHTING

Asgard

Builder	Abeking & Rasmussen
Year/Refit	1993/2021
LOA	42.84m (140' 6")
Beam	8.4m (27' 9")
Draft	3m (10' 5")
Cabins	4
Guests	8
Speed	12/10 kts
Price	€8,900,000



A Hill Robinson Company



Salon



Salon



Master Bedroom



Dining Room



Master Bedroom



Master Bathroom



Owner's Office



VIP Bedroom



Twin Bedroom



Navigation Room



Sun Deck















Asgard



19

Abeking & Rasmussen









MAIN SPECIFICATIONS

Flag	Virgin Island, British
Length	42.84m (140' 6")
Beam	8.4m (27' 9")
Draft	3m (10' 5")
Gross Tonnage	152
Year Built	1993/2021
Builder	Abeking & Rasmussen
Naval Architect	Bruce King Yacht Design
Interior Design	Winch Design
Exterior Design	Bruce King Yacht Design
Hull Construction	Wood sheathed in GRP (70mm thick planks)
Superstructure	Wood

MACHINERY

Main Engines	1 x MTU 985 HP, 12V 183 TE92 (Full MTU W6 rebuild 2020/1 refit)
Engine Hours (September 2023)	28,185 Hours
Gearbox	Make ZF BW 195 ratio 2.571:1 (rebuilt 2020/1 refit)
Shafts	One
Power	985hp/ 735kW
Propulsion	Single screw propeller (Schaffran CPP)
Speeds	8-10 Knots under power, 190M p/d planning speed under sail/power
Range Under Power	1,680 nm

AUXILIARY MACHINERY & ELECTRICAL SYSTEM

Port Generator (September 2023)	Northern Lights 30 kw; model number M1064D-33 kw
Starboard Generator (September 2023)	Northern Lights 50 kw; model number M6414D-501
Generator Hours (September 2023)	Port 7,103.3 Hours Stbd 3,292.4 Hours
Electric Power	3 phase 50Hz
Electrical	220v single phase
Shore Power	ASEA shore power transformer 50/60 Hz
Batteries	1 x main engine start, 1 x 30 Kw gen start, 1 x 50 kw gen start. Domestic: 4000 Ah (DC power bank for DC hydraulics) 48 2v cells (renewed 2020/1 refit)

SAILING & RIGGING

Rigging type	Double headsail ketch
Sail maker	Doyle UK
Sail total area	680m ²
RIG Measurements	Main mast 42m (keel stepped) Mizzen Mast 33m (keel stepped)
Spars	Southern Spars (Ultrasound survey 2020)
Standing Rigging	BSI
Running Rigging	Checked and replaced 2020 (THL)
Furling Gear	Reckmann
Winches	Lewmar (winches all serviced in 2020/1 refit by Lewmar)

TANK CAPACITIES (approximate)

Fuel Consumption	960 liters - approximate
Fuel Tanks x 5	10,245 liters- total
Fresh water x 2	6,400 liters
Grey/Black Water	3 x Grey Tanks: Total 1,470 lts 2 x Black Tanks: Total 720 lts

ANCILLARY EQUIPMENT

Hydraulics	2020/1 refit: all hoses replaced, PVG valves serviced, All HPU's replaced
Bilge/Fire Pump	Calpeda 4 Kw
Air Conditioning	Condaria
Steering System	Conventional wheel (cable & quadrant)
Boilers	2 x Calorifiers (1 Fwd 150 l 1 Aft 150l)
WC's	Altena

SAFETY & SECURITY EQUIPMENT

Safety

- 4 x liferings
- 2 x MOB smoke floats
- 2 x Jon Buoys
- 15 x immersion suits
- 25 x inflatable lifejackets
- 2 x IPIRB's
- 2 x SARTS
- 2 x GMDSS emergency handheld radios

Medical

MCA CAT A

Fire

- 2 x firemen's suits and BA's
- 2 x hoses
- 4 x hydrants
- 23 x fire extinguishers
- 15 x heat and smoke detectors

Alarms & Monitoring

- 3 x carbon monoxide detectors

Security

- 4 x CCTV

COMMUNICATION EQUIPMENT

Satcoms	Inmarsat C (Sailor 6006) VSAT (Sailor ACU)
Cell/Wifi	Pepwave, Yotspot
VHF Radiotelephones	2 x fixed, 2 x portable
Telephone	MF/HF Sailor 6300 DSC

NAVIGATION EQUIPMENT

Gyro Compass	Raytheon STD 22 (serviced with new sphere 2021)
Automatic Pilot	AP70 Mk II
Echo Sounder	Furuno Fishfinder & Airmar DST
Radar	4g & Furuno X-band
Chart Plotter	Simrad & Maxsea Pro
DGPS	Saab R5
Navtex	Mcmurdo
Wind Instruments	B&G Hercules
AIS	Saab R5 class A
Raytheon STD 22	(serviced with new sphere 2021)

AUDIO/VISUAL ENTERTAINMENT SYSTEM

- 2 x Yamaha AMPS
- 2 x AppleTV Blue Ray DVD
- 1 x Play-Station PS4
- 1 x Overhead projector
- 1 x Samsung 48" TV

DOMESTIC EQUIPMENT

- 1 x Dishwasher
- 1 x Dryer
- 1 x Washing machine
- 1 x Oven and hob
- 1 x Microwave
- 1 x Vacuum cleaner
- 1 x Custom fridge and Freezer in galley
- 1 x Quooker - (instant hot water)
- 1 x JURA coffee machine

TENDERS & WATER TOYS EQUIPMENT

Tenders

- Zar Rib
- 70 hp Yamaha
- 4m Inflatable
- 25 hp Yamaha

ACCOMODATION

Cabins	4 (1 Owner, 2 Double, 1 Twin)
Guests	8
Crew	Captain + 5
Master Cabin	Ensuite Double Cabin, 1 double bed
Guests Cabins	3 Double Cabins, x 2 single bed, 1 x double bed (separate toilets shared showers)
Crew Cabins	3 x Double Cabins, Bunk beds (separate toilets, shared showers)

WORK LIST/REFIT

2021

Both generators and main engine were completely rebuilt back to zero hours at refit launch (May 2021)

PRICE

€8,900,000

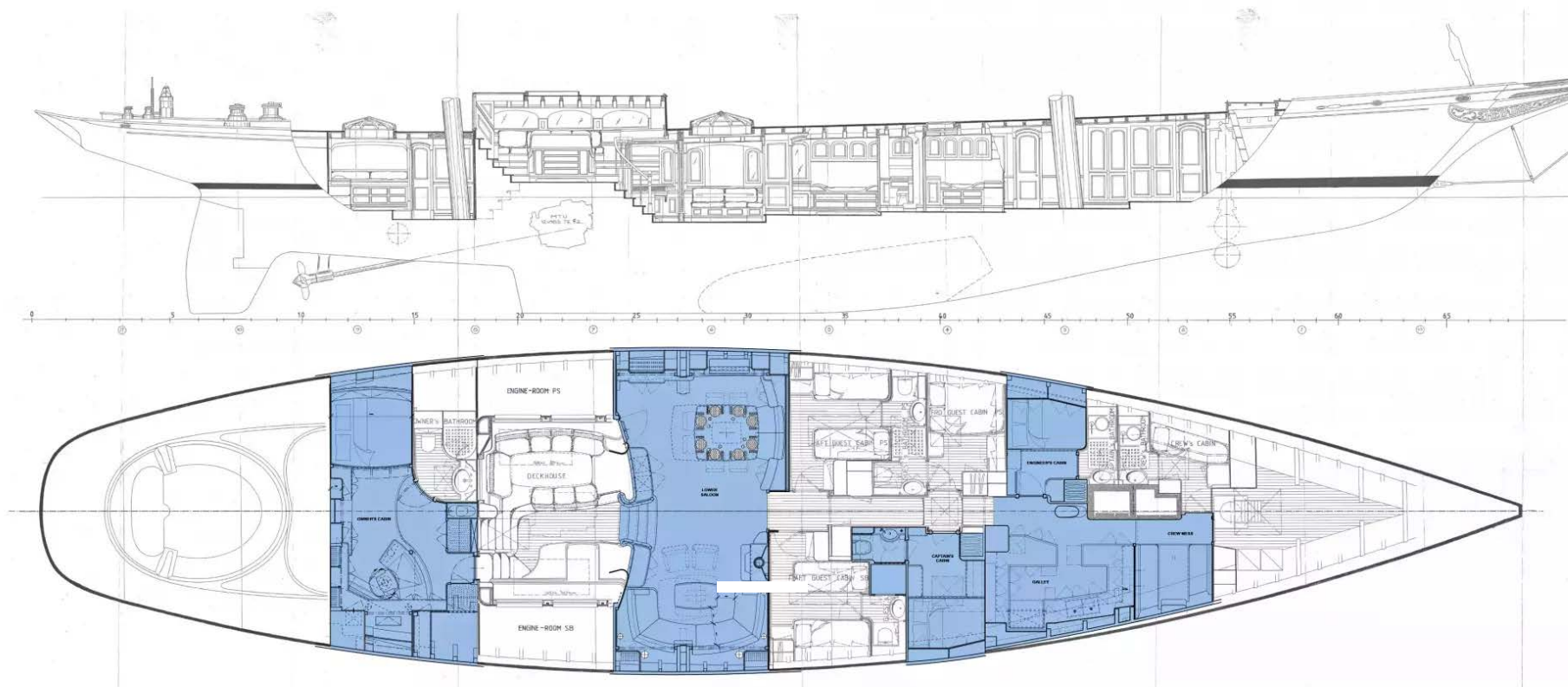

These particulars have been prepared from information provided by the sellers and are intended as a general guide to the vessel. We cannot, however, be liable for any inaccuracy. It is up to the purchaser to confirm details of concern to him by survey, inspection and/or enquiry of the seller and to ensure that the purchase contract properly reflects his concern and specific details upon which he may rely. We always advise an independent survey.



Moravia

YACHTING

Contact

Adam Papadakis

Head of Sales / Senior Sales Broker

+377 6 78 63 39 60 | adam.papadakis@moraviayachting.mc

moraviayachting.mc

While every effort has been made to ensure that the information contained in this document is accurate as at the date of production, the accuracy of such information cannot be guaranteed. Moravia Yachting gives no representation, warranty or undertaking, express or implied, as to: the accuracy, reliability, completeness or reasonableness of the information contained in this document; the condition of a featured yacht and/or its equipment; the seaworthiness of a featured yacht; or the suitability and/or availability of a featured yacht for purchase or charter. The fees, specifications, figures, images and comments included in this document are subject to change without notice. This document has been produced by Moravia Yachting at the request of the person identified on the front cover for discussion purposes only and is confidential. This document must not be copied or distributed to any third party, in whole or part, without Moravia Yachting's express written permission. Moravia Yachting hereby expressly excludes any liability howsoever arising in respect of any inaccuracies or errors in the information contained in this document, to the fullest extent permitted by law.