



Moravia

YACHTING



St-Barth

Builder	St-Barth Yachting
Year/Refit	2021
LOA	24m (78' 75")
Beam	5.8m (19' 02")
Draft	1.4m (4' 6")
Cabins	4
Guests	6/8
Speed	25/18 kts
Price	€5,800,000 VAT Paid



A Hill Robinson Company





Main Deck - Salon



Main Deck - Salon



Main Deck - Salon



Bridge Deck - Salon



Bridge Deck - Helm



Master Cabin



Double Cabin - Guest



Double Cabin - Guest



Foredeck and Jacuzzi



Foredeck and Jacuzzi



Jacuzzi









MAIN SPECIFICATIONS

Flag	Netherlands
Length	24m (78' 5")
Beam	5.8m (19' 02")
Draft	1.4m (4' 6")
Gross Tonnage	54
Year Built	2021
Builder	St-Barth Yachting
Naval Architect	Wijk Yacht Creations
Interior Design	AR Design
Exterior Design	Wijk Yacht Creations / AR Design
Hull Construction	Aluminium
Superstructure	Aluminium
Classification	CE Ocean A Classification

MACHINERY

Main Engines	2 x Volvo Penta IPS
Speed	Maximum Speed : 25 Cruising Speed : 18

AUXILIARY MACHINERY & ELECTRICAL SYSTEM

Generator	20 kW Northern Light
Electric Power	220-240 V
Shore Power	Victron Quattro
Batteries	1560 AH package

TANK CAPACITIES (approximate)

Fuel Capacity	4,500 litres
Water Capacity	1,200 litres
Grey Water	600 litres
Black Water	800 litres

ANCILLARY EQUIPMENT

Stabilisers	Humphree zero speed
Air Conditioning	Mavé

NAVIGATION EQUIPMENT

Magnetic Compass	Garmin
Gyro Compass	Garmin
Radar	Garmin
GPS	Garmin

DOMESTIC EQUIPMENT

- Miele washer and dryer
- Miele induction, tepenyaki, steam combi and sous vide cooking
- Winterhalter professional dishwasher
- Vertifigo freezer, refrigerator, icemaker
- Jura Z10 coffe machine
- 2 x Liebherr wine coolers

OTHER EQUIPMENT

Jacuzzi	4 persons jacuzzi (1600 ltr)
---------	------------------------------

TENDERS & WATER TOYS EQUIPMENT

Tender	330 AB Jet tender
--------	-------------------

ACCOMODATION

Cabins	4
Guests	6/8

PRICE

€5,800,000 VAT Paid

General Arrangement

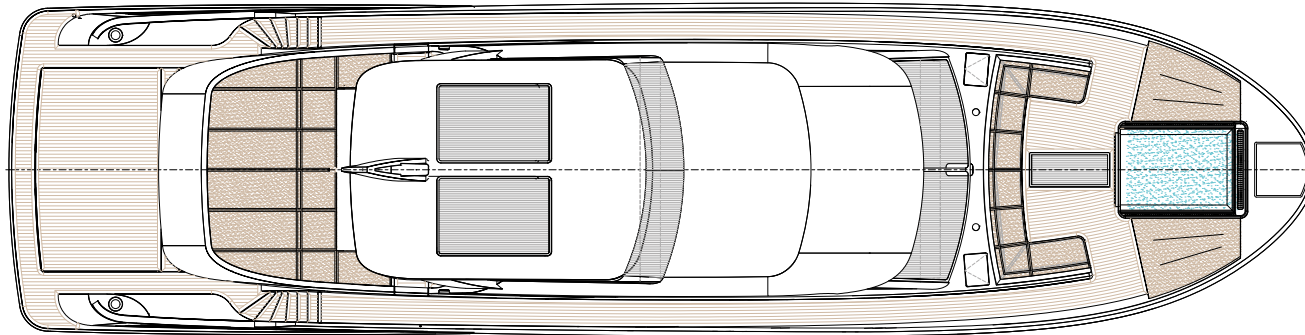

Top View

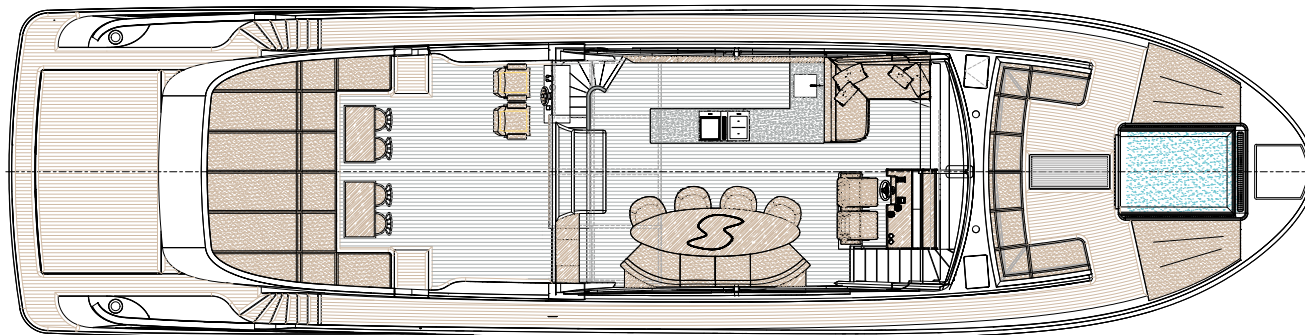

Flybridge Deck

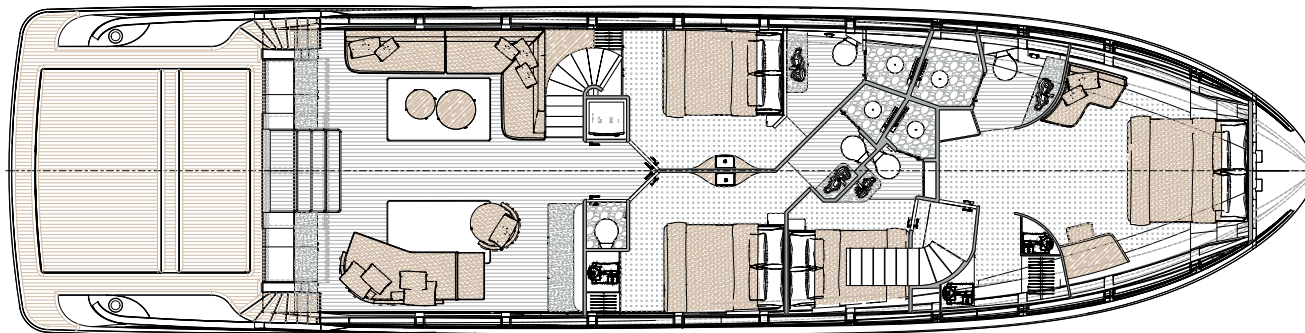

Main Deck

These particulars have been prepared from information provided by the sellers and are intended as a general guide to the vessel. We cannot, however, be liable for any inaccuracy. It is up to the purchaser to confirm details of concern to him by survey, inspection and/or enquiry of the seller and to ensure that the purchase contract properly reflects his concern and specific details upon which he may rely. We always advise an independent survey.



Moravia

YACHTING



Contact

Tim Carbury
Sales Broker

+377 643 912 570 | tim.carbury@moraviayachting.mc

moraviayachting.mc

While every effort has been made to ensure that the information contained in this document is accurate as at the date of production, the accuracy of such information cannot be guaranteed. Moravia Yachting gives no representation, warranty or undertaking, express or implied, as to: the accuracy, reliability, completeness or reasonableness of the information contained in this document; the condition of a featured yacht and/or its equipment; the seaworthiness of a featured yacht; or the suitability and/or availability of a featured yacht for purchase or charter. The fees, specifications, figures, images and comments included in this document are subject to change without notice. This document must not be copied or distributed to any third party, in whole or part, without Moravia Yachting's express written permission. Moravia Yachting hereby expressly excludes any liability howsoever arising in respect of any inaccuracies or errors in the information contained in this document, to the fullest extent permitted by law.