



ARKSEN 85

Builder	Wight Shipyard / Arksen
Year	2026
LOA	27.4m (89' 11")
Beam	7m (23')
Draft	1.55m (5' 1")
Cabins	5
Guests	8/10
Maximum Speed	14 Knots
Cruising Speed	12 Knots
Price	£9,950,000



MAIN DECK SALON





BRIDGE DECK SALON





BRIDGE DECK SALON





BRIDGE DECK SALON





MASTER CABIN





MASTER CABIN - EN SUITE





MASTER CABIN - LOWER DECK





DOUBLE CABIN





TWIN CABIN





GUEST CABIN



OFFICE





GALLEY



YACHT SPECIFICATIONS

DIMENSIONS

Length	27.4m (89' 11")
Beam	7m (23')
Draft	1.55m (5' 1")

GENERAL

Year	2026 or 18 months from signature
Builder	Wight Shipyard / Arksen
Naval Architect	Humphreys Yacht Design
Interior Design	Design Unlimited
Exterior Design	Humphreys Yacht Design
Hull Construction	Aluminium
Superstructure	Aluminium
Classification	UK MCA MGN280(m), 'unrestricted' Category 0

MACHINERY

Engines	2x 250kW Electric motors or 2x Scania 294kW (300hp) diesel engines
Engines Hours	Newbuild
Gearboxes	2x ZF550V marine RR remote V-drive gearboxes
Propellers	5 blade nickel aluminum bronze
Consumptions	TBC
Maximum Speed	14 Knots
Cruising Speed	9-12 Knots
Range	7,000 nm

AUXILIARY MACHINERY & ELECTRICAL SYSTEM

Generators

For conventional propulsion there's a Kohler 35ekW
For hybrid propulsion there are 2x 200 kW gens

Generators Hours Newbuild

Electric Power

- AC power by generator, shore power, or inverter
- Batteries charged by generator, solar pannels or shore power

Shore Power 50hz 63Amp & 60hz 63Amp

Batteries

- 160kWh LiFePO4 Propulsion/House Batteries in A60 Battery Room
- 200 Ah LiFePO4 24V DC Service Battery Bank
- 300 Ah LiFePO4 24V DC Emergency Battery Bank
- 100 Ah LiFePO4 24V DC GMDSS Battery Bank

TANK CAPACITIES (approximate)

Fuel Capacity	17,500 liters
Water Capacity	6,000 liters
Waste Water	1,250 liters
Sludge	410 liters
Waste oil	500 liters

GENERAL

Bow Thruster	36kW
Stern Thruster	36kW
Stabilisers	Fin Stabilisers and Gyro Stabilisers and Interceptors and Zero Speed passive roll dampers
Air Conditioning	Variable frequency matching load to demand to avoid on/off cycling

COMMUNICATION EQUIPMENT

- 2x Furuno FM4800 VHF/DSC
- 1x Iridium GMDSS
- 1x Starlink High Performance antenna
- 1x Yellowbrick YB3i tracker
- 1x Pepwave MAX BR1 MK2

Onboard Wi-Fi network

Other communications systems can be installed, the Owner's specific requirements, including Iridium Certus, for example

NAVIGATION EQUIPMENT

- 1x Furuno DRS6A-NXT open array radar antenna
 - 1x Furuno GP330B GPS antenna
 - 1x Furuno SC33 GPS compass
 - 1x Furuno PG700 Solid state rate gyroscope fluxgate compass
 - 1x Airmar DST800 Depth/Speed/Temperature transducer
 - 1x Furuno FA-70 Class B SOTDMA AIS transponder
- Optionally, additional equipment can be installed, to the Owner's requirements, including FLIR thermal imaging cameras, as an example



YACHT SPECIFICATIONS

DIMENSIONS

Outriggers to be used as

- 'Flopper stopper' passive at-anchor stabilisation system
- Tender launch and recovery
- Crane for stores and equipment
- Support for standard passerelle
- Support for aft deck awnings

Anchors

- Primary bow 130kg CGR type with 140m of 14mm galvanised stud linked chain
- Stern (optional) 21kg Fortress with 12m of 12mm galvanised chain

Windlasses

- 2x Lewmar V8 vertical stainless windlasses on bow
- Mooring bollards or optional Andersen 62STFS electric winches on aft deck

Tender Handling & Storage

- Launched and recovered by Outriggers or optional hydraulic crane on aft deck
- Stored on chocks on aft deck or extendable outboard tender chocks
- Deck fastening system - multipurpose fastening system used throughout decks for lashings and securing deck furniture, swim ladder, tender chocks etc.
- Optional bow davit for lifting smaller tenders and toys

CONSTRUCTION

A Sonos audio system is included in the main saloon and bridge deck saloon. There are various options available for audio/visual systems, that can be tailored to the Owner's specific requirements, including Media servers, Televisions/speakers in interior spaces, exterior AV packages

ACCOMODATION

- 1x full beam master cabin with king bunk. Ensuite with optional steam room in shower enclosure. 'Bonus' room to starboard can be configured as office, snug, or with a pullman bunk
- 2x ensuite convertible guest cabins
- 1 or 2 forward cabins with 2x bunks and ensuite. Can be configured as crew cabins, but finished to guest standards. If 1 cabin is chosen then port side turns into utility space with laundry, and additional extensive storage space



GENERAL ARRANGEMENT

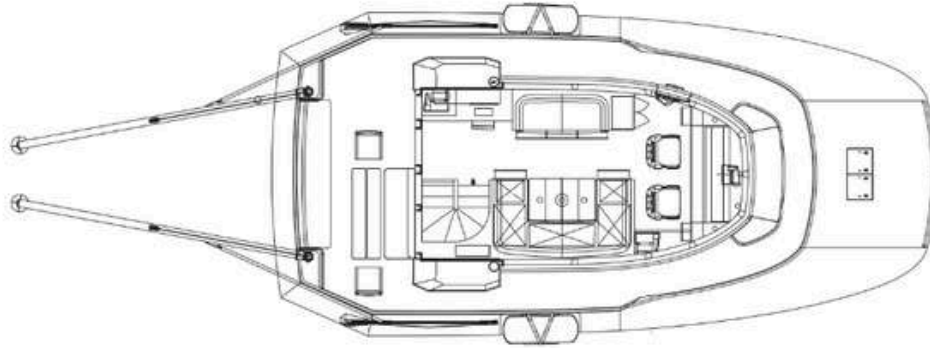

UPPER DECK

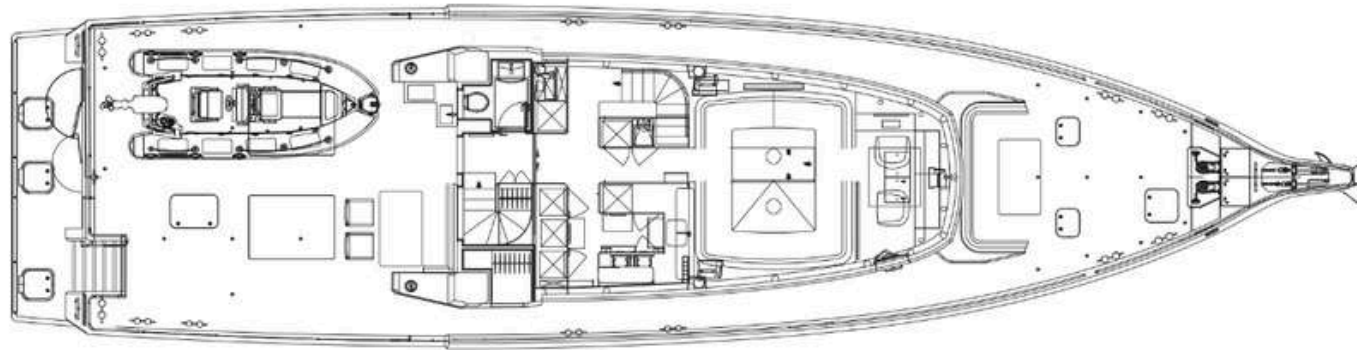

MAIN DECK

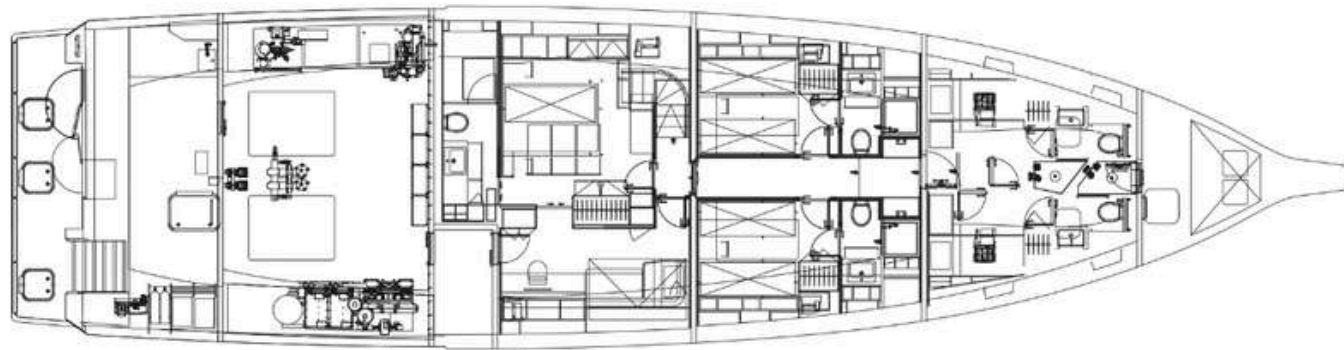

LOWER DECK





CONTACT

Sam Tucker
Sales Broker

+44 7548 765406
sam.tucker@moraviayachting.mc

While every effort has been made to ensure that the information contained in this document is accurate as at the date of production, the accuracy of such information cannot be guaranteed. Moravia Yachting gives no representation, warranty or undertaking, express or implied, as to: the accuracy, reliability, completeness or reasonableness of the information contained in this document; the condition of a featured yacht and/or its equipment; the seaworthiness of a featured yacht; or the suitability and/or availability of a featured yacht for purchase or charter. The fees, specifications, figures, images and comments included in this document are subject to change without notice. This document has been produced by Moravia Yachting at the request of the person identified on the front cover for discussion purposes only and is confidential. This document must not be copied or distributed to any third party, in whole or part, without Moravia Yachting's express written permission. Moravia Yachting hereby expressly excludes any liability howsoever arising in respect of any inaccuracies or errors in the information contained in this document, to the fullest extent permitted by law.

 A Hill Robinson company

Moravia
YACHTING