



# M&M

## For Sale

Builder	Sanlorenzo
Year/Refit	2020
LOA	26.7m (87' 6")
Beam	7.2m (23' 6")
Draft	1.7m (5' 5")
Cabins	4
Guests	8
Maximum Speed	23 Knots
Cruising Speed	20 Knots
Price	€5,300,000 VAT Paid



**Moravia**  
YACHTING





MAIN SALON





MAIN SALON





MAIN SALON





DINING





DINING



DINING







DINING





STAIRS





MASTER BEDROOM





MASTER BEDROOM





**MASTER BEDROOM**



MASTER BEDROOM





**MASTER BATHROOM**



VIP CABIN







VIP CABIN





VIP CABIN





TWIN CABIN





GUEST CABIN - BATHROOM





**GUEST CABIN - BATHROOM**





GUEST CABIN - SHOWER





GALLEY





GALLEY







LAUNDRY AND CREW





BRIDGE





MAIN DECK





MAIN DECK



MAIN DECK





FRONT DECK





FRONT DECK





FRONT DECK







AFT DECK





AFT DECK





AFT DECK





FLY BRIDGE





UPPER DECK





UPPER DECK





UPPER DECK





UPPER DECK







UPPER DECK





UPPER DECK





UPPER DECK





UPPER DECK



# YACHT SPECIFICATIONS

## MAIN SPECIFICATIONS

<b>Length</b>	26.7m (87' 6")
<b>Beam</b>	7.2m (23' 6")
<b>Draft</b>	1.7m (5' 5")
<b>Gross Tonnage</b>	116
<b>Year Built</b>	2020
<b>Builder</b>	Sanlorenzo
<b>Naval Architect</b>	Sanlorenzo
<b>Interior Designer</b>	Lissoni Associati
<b>Exterior Designer</b>	Officina Italiana Design
<b>Hull Construction</b>	GRP
<b>Superstructure</b>	GRP
<b>Decks</b>	Teak
<b>Paint system</b>	Gel Coat
<b>Classification</b>	Rina
<b>Flag</b>	Italy
<b>Port of Registry</b>	Italy

## ACCOMMODATION

<b>Number of Cabins</b>	4
<b>Total Guests</b>	8
<b>Total Crew</b>	3

## MACHINERY

<b>Main Engine</b>	3 x IPS 1050 Volvo - 800 HP
<b>Manufacturer</b>	Volvo
<b>Engines Hours</b>	
Total port engine hours:	339
Total central engine hours:	339 (Jan 2025)
Total stb. Engine hours:	339
<b>Maximum speed</b>	23 Knots
<b>Cruising speed</b>	20 Knots
<b>Range at cruising speed</b>	570 nm
<b>Range at economical speed</b>	1120 nm at 10 Knots
<b>Main Generator</b>	Kohler 1x35 kw / Kohler 1x 28kw
<b>Generator hours</b>	1000 hours

## TANK CAPACITY (approximate)

<b>Fuel Oil Tank Capacity</b>	9,300 liters
<b>Water Capacity</b>	2,050 liters
<b>Black Water</b>	550 liters

## ANCILLARY EQUIPMENT

<b>Steering System</b>	YES
<b>Bow Thruster</b>	YES
<b>Trimtabs</b>	YES
<b>Stabilisers</b>	Fin stabilizers, underway and zero speed
<b>Bilge/Fire Pump</b>	YES
<b>Boilers</b>	150 liters
<b>Watermarker</b>	180 liters/hour
<b>Idromar</b>	
<b>Heating</b>	Inverter A/C YES
<b>Air Conditioning</b>	In cabins, salon and flybridge

## SAFETY & SECURITY EQUIPMENT

**Fuel Capacity**  
– 2 x 400 litres fuel tanks 150 litres day tank filled with electric pump with manual back up

**Water Capacity**  
– 2 x 340 litres fresh water capacity

These particulars have been prepared from information provided by the sellers and are intended as a general guide to the vessel. We cannot, however, be liable for any inaccuracy. It is up to the purchaser to confirm details of concern to him by survey, inspection and/or enquiry of the seller and to ensure that the purchase contract properly reflects his concern and specific details upon which he may rely. We always advise an independent survey.



# YACHT SPECIFICATIONS

## NAVIGATION EQUIPMENT

---

- Magnetic Compass
- Rudder indicator
- Automatic Pilot
- Log
- Echo Sounder
- Radar
- GPS
- Wind Instruments

## CONSTRUCTION

---

- Anchors
- Windlasses
- Cranes
- Capstans
- 2x Stern Winches
- Submersible Bathing Platform
- Swimming ladder
- Passarelle
- Sun Awning
- Search light & Horn
- Hard Top with electric opening roof with blades

## AUDIO/VISUAL ENTERTAINMENT SYSTEM

---

- Satellite TV in Salon 55', Playroom, Master 40', VIP and guest 24'
- TV Home Cinema/Hi-Fi/Bluetooth in Salon
- Hi-Fi/Bluetooth in Master and VIP cabins
- Hi-Fi/Bluetooth in twin cabins
- Mobile high-speed internet systems with harbour hot spot

## DOMESTIC EQUIPMENT

---

### Galley equipment

- Refrigerators in galley and deck
- Freezers
- Ovens
- Ceramic hot plate Miele 75 cm
- Microwaves
- Dishwashers
- Other Miele Wine Cooler in dining area

### Laundry equipment

- Washing Machines
- Dryers

These particulars have been prepared from information provided by the sellers and are intended as a general guide to the vessel. We cannot, however, be liable for any inaccuracy. It is up to the purchaser to confirm details of concern to him by survey, inspection and/or enquiry of the seller and to ensure that the purchase contract properly reflects his concern and specific details upon which he may rely. We always advise an independent survey.



# GENERAL ARRANGEMENT

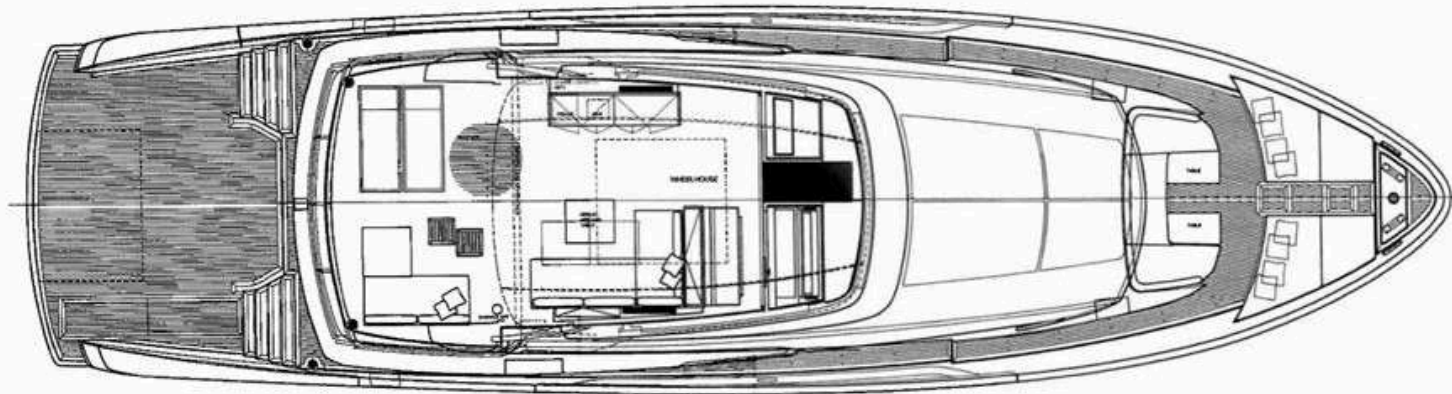

**FLY BRIDGE**

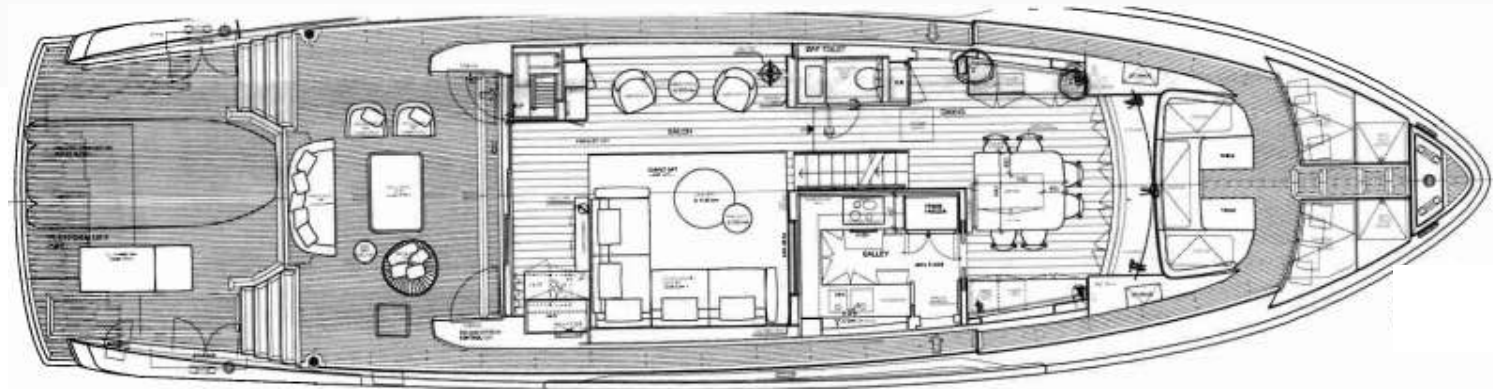

**MAIN DECK**

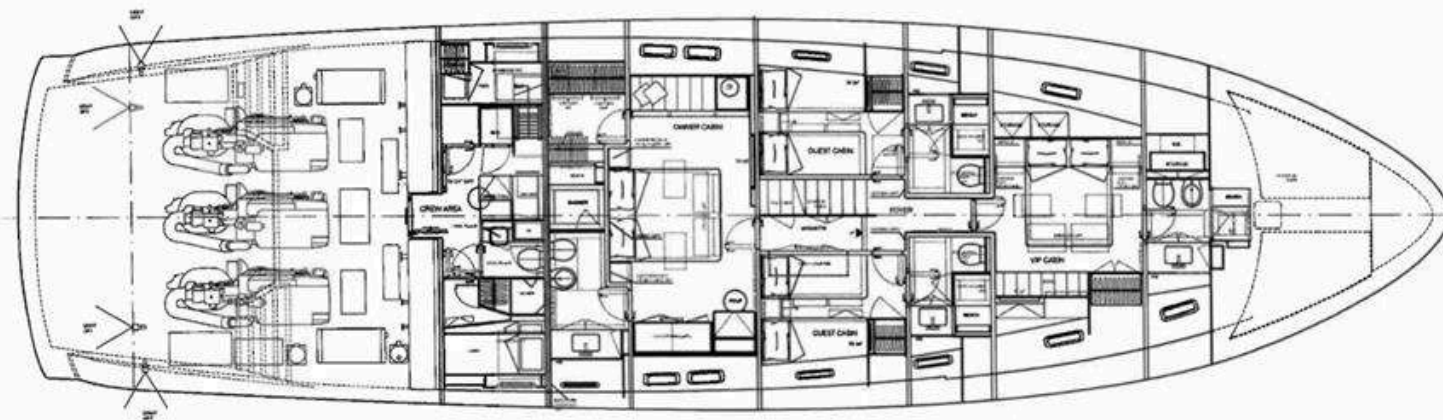

**LOWER DECK**

## CONTACT

**Alessandro Diomedì**  
Sales Broker

+377 6 43 91 90 54

[alessandro.diomedì@moraviayachting.mc](mailto:alessandro.diomedì@moraviayachting.mc)  
[moraviayachting.mc](http://moraviayachting.mc)

While every effort has been made to ensure that the information contained in this document is accurate as at the date of production, the accuracy of such information cannot be guaranteed. Moravia Yachting gives no representation, warranty or undertaking, express or implied, as to: the accuracy, reliability, completeness or reasonableness of the information contained in this document; the condition of a featured yacht and/or its equipment; the seaworthiness of a featured yacht; or the suitability and/or availability of a featured yacht for purchase or charter. The fees, specifications, figures, images and comments included in this document are subject to change without notice. This document has been produced by Moravia Yachting at the request of the person identified on the front cover for discussion purposes only and is confidential. This document must not be copied or distributed to any third party, in whole or part, without Moravia Yachting's express written permission. Moravia Yachting hereby expressly excludes any liability howsoever arising in respect of any inaccuracies or errors in the information contained in this document, to the fullest extent permitted by law.

 A Hill Robinson company

  
**Moravia**  
YACHTING