



Moravia

YACHTING



Rebecca V

Builder	Benetti
Year/Refit	2009
LOA	25.8m (84' 6")
Beam	6.75m (22' 1")
Draft	3.27m (10' 7")
Cabins	4
Guests	10
Speed	13/10 kts
Range	4,000 nm @ 8 kts
Price	€2,750,000 ex VAT



A Hill Robinson Company













Main Salon



Main Salon



Dining



Dining



Master Cabin



Master Cabin - En Suite



Twin Cabin



Twin Cabin - En Suite



Bridge



Starboard walkway on Main Deck



Sun Deck



Aft Deck Dining



Sun Deck



Water Toys



Water Toys

MAIN SPECIFICATIONS

Length	25.8m (84' 6")
Beam	6.75m (22' 1")
Draft	3.27m (10' 7")
Gross Tonnage	103
Year Built/Refit	2009
Builder	Benetti
Naval Architect	Benetti
Interior Design	Zuretti Interior Design
Draft Exterior Design	Stefano Righini Design
Hull Construction	GRP
Superstructure	GRP
Classification	CE / RINA
Price	€2,750,000 ex VAT

MACHINERY

Main Engines	2 x Cat 18 651kW
Engines Hours	4,360 each (April 2024)
Gearboxes	2 x Reintjes 1:4.053 reduction
Shafts	2 x direct shafts
Propellers	2 x fixed pitch propellers

Speed, Consumption, Range

	Speed	Consumption lph (combined with gen)	Range (nm)
Max	13	300	700
Cruising	10	110	1,600
Economical	8	40	4,000

AUXILIARY MACHINERY & ELECTRICAL SYSTEM

Main Generators	2 x Kohler 40 kW
Generators Hours	P: 8,050 S: 8,363 (April 2024)
Emergency Generator	N/A
Electrical	24V & 220V throughout
Shore Power	220v
Batteries	230Ah X 4

ANCILLARY EQUIPMENT

Steering System	BSC Steer 2000
Bow Thruster	Naiad 28 kW
Stern Thruster	Naiad 28kW
Stabilisers	Naiad fins
Bilge/Fire	2 x 120l with 6Kw
Pump Boilers	

Cooling Water System	N/A
Air Conditioning	Frigomar - 310 series 0798NT 6,000 BTU, 9,000 BTU 18,000 BTU Total 33,000 BTU

SAFETY & SECURITY EQUIPMENT

Safety	Full set of fully serviced equipment as specified by flag
Fire	Integrated Consilium fire monitoring system

COMMUNICATION EQUIPMENT

Satcom	Seatel
VHF Radiotelephones	Sailor DSC VHF + 4 handheld 2 icom IC25 + 2 GMDSS approved + 2 emergency batteries
Telephone	Thrane & Thrane
UHF Communications	Yes 3 x Icom

NAVIGATION EQUIPMENT

Magnetic Compass	White Star
Automatic Pilot	Simrad
Log	Integrated
Echo Sounder	Simrad
Radar	1 x simrad 1 x nobeltec
Chart Plotter	TimeZero and Simrad
Navtex	Furuno
Wind Instruments	Furuno
AIS	Smart find

NAVIGATION EQUIPMENT (Flybridge)

- Simrad touchscreen display
- 2 x engine temperature and pressure gauges
- Magnetic compass
- 2 x windlass controllers with chain counters
- Simrad autopilot
- Bow & stern thruster controls
- Engine start/stop controls

DECK EQUIPMENT

- 1 x Opacmare 500kg crane
- 2 x Anchors
- 2 x 150m chain
- 2 x Maxwell 3000 winches on aft deck

AUDIO/VISUAL ENTERTAINMENT SYSTEM

- Flat screen monitors in every cabin plus salon
- Music system throughout

DOMESTIC EQUIPMENT

Galley

- Fully equipped with Miele appliances

Sundeck

- Electric Miele outdoor cook top
- Drinks Fridge
- Ice Maker

Aft Deck

- Drinks fridge

TENDERS & WATER TOYS EQUIPMENT

Tenders

- 1 x 4.2m Joker Boat RIB with Mercury 60hp outboard
- 1 x PWC (Jet Ski) SEA-DOO 90HP new in 2023

Toys

Towables:

- Wakeboard
- Kneeboard
- Waterskis
- Inflatable donut

Kayak

Paddleboard

Snorkelling equipment

ACCOMODATION

- Detailed accommodation
- Main deck master cabin
- Lower deck full beam VIP cabin
- 2 x twin cabins with 1 x double and 1 x fixed single bed each
- Total 6 fixed beds, 4 doubles, and 2 singles total 10 pax overnight
- All cabins en-suite

WORKS COMPLETED 2023/2024

- 4 x Service Batteries replaced
- Main engines and generators fully serviced
- Bow thruster serviced (in water)
- New bimini top
- Crance serviced
- Hull and topsides polished
- Teak treated with Semcoat
- Navigational upgraded - Flybridge now integrated with AIS, and new Furuno readout in crew cabin
- New icemaker on sundeck
- New SEA-DOO with cover
- New covers for exterior sun pads
- Tender serviced
- Swim platform serviced
- All Life Saving Appliances serviced or replaced as necessary
- External lamps replaced
- Water heater serviced (new elements installed)

General Arrangement

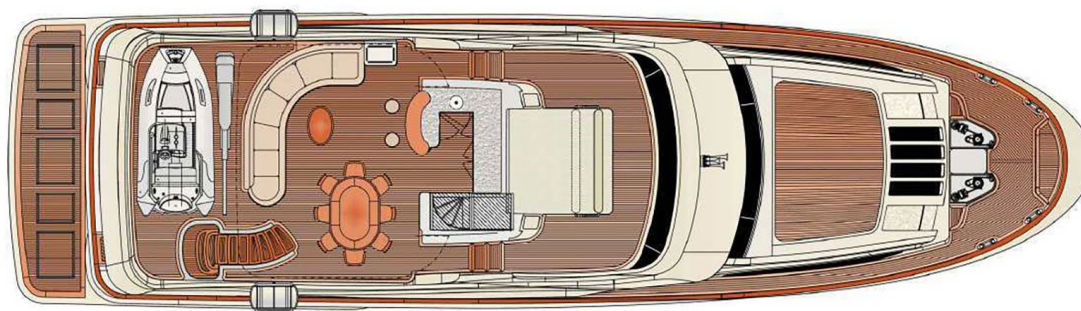

Sun Deck



Main Deck

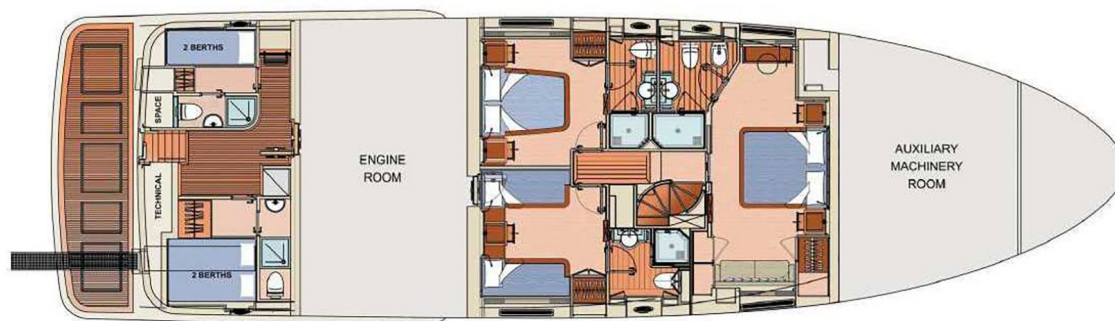

Lower Deck

These particulars have been prepared from information provided by the sellers and are intended as a general guide to the vessel. We cannot, however, be liable for any inaccuracy. It is up to the purchaser to confirm details of concern to him by survey, inspection and/or enquiry of the seller and to ensure that the purchase contract properly reflects his concern and specific details upon which he may rely. We always advise an independent survey.



Moravia

YACHTING



Contact

Sam Tucker

Sales Broker

+44 7548 765406 | sam.tucker@moraviayachting.mc

While every effort has been made to ensure that the information contained in this document is accurate as at the date of production, the accuracy of such information cannot be guaranteed. Moravia Yachting gives no representation, warranty or undertaking, express or implied, as to: the accuracy, reliability, completeness or reasonableness of the information contained in this document; the condition of a featured yacht and/or its equipment; the seaworthiness of a featured yacht; or the suitability and/or availability of a featured yacht for purchase or charter. The fees, specifications, figures, images and comments included in this document are subject to change without notice. This document must not be copied or distributed to any third party, in whole or part, without Moravia Yachting's express written permission. Moravia Yachting hereby expressly excludes any liability howsoever arising in respect of any inaccuracies or errors in the information contained in this document, to the fullest extent permitted by law.